

BOROUGH OF MANTOLOKING
Financial Report for the Month of AUGUST 31, 2019

Status of the Budget on AUGUST 31, 2019

FUND	APPROPRIATIONS	CURRENT BALANCE	EXPENDED DURING MONTH	ENCUMBERED DURING MONTH	APPROPRIATION BALANCE
2019 ADOPTED BUDGET	\$5,283,897	\$5,283,897	\$3,239,752	\$130,055	\$1,914,090
2018 RESERVE BUDGET- CURRENT	\$393,797	\$393,797	\$167,170	\$0	\$226,627
2019 CAPITAL FUND	\$1,950,425	\$1,950,425	\$91,591	\$566,869	\$1,291,537
SANDY EMERGENCY FUNDS	\$146,568	\$146,568	\$6,600	\$0	\$139,968
(Subcategory of Capital Fund)					
Construction-Municipal Building	\$5,312,704	\$450,631	\$47,784	\$139,661	\$263,186
TOTAL	\$7,803,494	\$2,941,421	\$313,145	\$706,530	\$1,921,317

Receipts, Disbursements and Changes in Cash Balance During the Month of AUGUST 31, 2019

FUND	CASH BALANCE JANUARY 1, 2019	CASH BALANCE BEGINNING OF MONTH	CASH RECEIVED	CASH DISBURSED	CASH BALANCE END OF MONTH
2019 CURRENT FUND	\$2,586,920	\$494,116	\$2,733,893	(\$469,891)	\$2,758,118
CAPITAL FUND	\$3,321,882	\$3,268,434	\$0	(\$22,716)	\$3,245,718
ANIMAL CONTROL FUND	\$183	\$219	\$5	\$0	\$225
OTHER TRUST FUNDS	\$511,133	\$529,442	\$238	(\$1,813)	\$527,868
PAYROLL ACCOUNT	\$39,647	\$48,649	\$238,874	(\$220,778)	\$66,745
UNEMPLOYMENT ACCOUNT	\$25,533	\$25,060	\$5	\$0	\$25,066
LAW ENFORCEMENT TRUST	\$2,841	\$2,844	\$1	\$0	\$2,845
TOTAL	\$6,488,139	\$4,368,765	\$2,973,015	(\$715,197)	\$6,626,583

BOROUGH OF MANTOLOKING
 CASH RECEIPTS
 July 31, 2019

<u>REVENUE SOURCE</u>	<u>REVENUE THIS MONTH</u>	<u>YEAR TO DATE</u>	<u>2019 AMOUNT</u>
SURPLUS		0.00	
MUNICIPAL COURT FINES	3,616.76	13,480.77 0.00	0.00
INT & COST ON TAXES	3,414.49	12,412.00	0.00
INT ON INVESTMENTS	1,407.65	9,352.97	0.00
SEWER REVENUE	23,669.27	134,537.56	0.00
STATE AID:			
LEG INT BLK GRANT		0.00	0.00
CMPTRA		0.00	0.00
ENERGY TAX	63,398.25	69,953.25	0.00
SUPL ENERGY TAX		0.00	0.00
FEMA		1,750.00	
HOMESTEAD REBATE		11,738.51	0.00
CONSTRUCTION CODE	9,040.00	121,937.00	0.00
CONSTRUCTION CODE FINES		0.00	
DCA FEES	403.00	6,726.00	
ZONING	1,625.00	12,725.00	
BEACH BADGES	52,771.40	199,261.61	0.00
GRANTS:			
RECYCLING TONNAGE		1,203.40	0.00
DRUNK DRIVING ENF		0.00	0.00
CLEAN COMMUNITIES		4,000.00	0.00
BODY ARMOR		0.00	0.00
SEA WALL GRANT (STATE AGREEMENT)		0.00	0.00
ALC REHAB		482.25	0.00
NJ TRANS TRUST-BAY AVE FLOOD MITIGATION		0.00	0.00
DISTRACTED DRIVER GRANT		0.00	0.00
DOT		0.00	0.00
ZONING GRANT		0.00	0.00
BULLET-PROOF VESTS		1,318.99	0.00
FEMA-BEACH PUSH		0.00	0.00
DRIVE SOBER OR GET PULLED OVER-HOLIDAY		0.00	0.00
HAZARD MITIGAATION GRANT		0.00	0.00
CLICK IT OR TICKET		0.00	0.00
CAPITAL SURPLUS		0.00	0.00
PETTY CASH		0.00	
RESERVE FOR PAYMENT OF BOND ANTIC NOTES		0.00	0.00
RESERVE FOR INSURANCE PROCEEDS		0.00	0.00
RES FOR SALE OF MUN ASSETS			0.00

BOROUGH OF MANTOLOKING
 CASH RECEIPTS
 July 31, 2019

<u>REVENUE SOURCE</u>	<u>REVENUE THIS</u>		<u>2019</u>
	<u>MONTH</u>	<u>YEAR TO DATE</u>	<u>AMOUNT</u>
RECEIPT FROM			
DELINQUENT TAXES	7,195.10	32,488.95	0.00
CURRENT TAXES RECEIVABLE	2,432,053.58	7,238,079.94	0.00
VETS & SR		0.00	0.00
PREPAID TAXES	130,313.18	159,041.58	0.00
M.R.N.A.:			
COPIES	7.00	58.01	0.00
CABLE TV FRANCHISE		0.00	0.00
INSURANCE		0.00	0.00
MISC.	229.92	1,738.30	0.00
PLANNING		0.00	0.00
FEES AND PERMITS	296.00	5,859.00	0.00
BUDGET REFUNDS	3,509.00	90,576.69	0.00
FLAGS	540.00	1,007.00	0.00
POLICE	60.00	205.00	0.00
SALE OF MUN ASSETS		50,000.00	0.00
RECYCLING		282.00	0.00
MAR LICENSE	20.00	53.00	0.00
LEA		167.05	0.00
MirNA - Off Duty	323.00	752.25	0.00
Due to Capital - FEMA		0.00	0.00
MOTOR VEHICLE FINES		447.00	0.00
OPRA		46.54	0.00
			0.00
INTERFUND		54.00	0.00
INVESTMENT		0.00	0.00
RESERVE FOR DEBT SERVICE		48,482.84	0.00
FEMA-PPDR REIMBURSEMENT		0.00	0.00
SPECIAL EMERGENCY NOTE		0.00	0.00
TOTAL REVENUE	2,733,892.60	8,230,218.46	0.00

BOROUGH OF MANTOLOKING
 CAPITAL IMPROVEMENTS
 AS OF AUGUST 31, 2019

ORD #	ORD NAME	BALANCE AS OF 1/1/2019	2014 AUTH/ CANCELLED	PAID	PAID TO DATE	BALANCE	BAL FUNDED	BAL UNFUNDED
#518	FLAP VALVE	66.73	0.00	0.00	0.00	66.73	66.73	0.00
#534	BORO GARAGE	65,991.29	0.00	4,620.00	4,620.00	61,371.29	61,371.29	0.00
#551	SANITARY FORCE MAI	12,462.94	0.00	0.00	0.00	12,462.94	12,462.94	0.00
#566	SOLAR PANELS	16,883.20	0.00	0.00	0.00	16,883.20	16,883.20	0.00
#569	SANITARY SEWERS	54,671.12	0.00	0.00	0.00	54,671.12	54,671.12	0.00
#581	BERGEN LAGOON LAN	30,000.86	0.00	0.00	0.00	30,000.86	30,000.86	0.00
#582	SANITARY FORCE MAI	20,000.33	0.00	0.00	20,000.33	0.00	0.00	0.00
#583	STORM SEWER INSPEC	4,778.18	0.00	0.00	0.00	4,778.18	4,778.18	0.00
#585	FLAP VALVE PROGRAI	11,000.00	0.00	0.00	0.00	11,000.00	11,000.00	0.00
#586	BERGEN CHANNEL	862.75	0.00	0.00	0.00	862.75	862.75	0.00
#595	OLD BRIDGE/BAY AVE	0.00	0.00	0.00	0.00	0.00	0.00	0.00
#597	FIREHOUSE APRON	5,632.45	0.00	0.00	0.00	5,632.45	5,632.45	0.00
#598	BTMUA IMPROVEMEN	1,050.58	0.00	0.00	0.00	1,050.58	1,050.58	0.00
#599	FLAP VALVE PROGRAI	936.75	0.00	0.00	0.00	936.75	936.75	0.00
#600	ADA WALKWAY#4	15,929.65	0.00	0.00	0.00	15,929.65	15,929.65	0.00
#601	E.M. RADIOS	1,490.10	0.00	0.00	0.00	1,490.10	1,490.10	0.00

ORD # ORD NAME	BALANCE AS OF 1/1/2019	2014 AUTH/ CANCELLED	PAID	PAID TO DATE	BALANCE	BAL FUNDED	BAL UNFUNDED
#607 OLD BRIDGE/BAY AVE	755.09	0.00	0.00	0.00	755.09	755.09	0.00
#608 REPLACE FIREHOUSE	15,658.34	0.00	0.00	0.00	15,658.34	15,658.34	0.00
#609 POLICE CAMERAS	9,638.00	0.00	0.00	9,548.00	90.00	90.00	0.00
#610 BAY AVE DRAINAGE	0.00	0.00	0.00	0.00	0.00	0.00	0.00
#611 WALKWAY #4	726.94	0.00	0.00	0.00	726.94	726.94	0.00
#612 LYMAN ST WALKWAY	0.00	0.00	0.00	0.00	0.00	0.00	0.00
#626 HERBERT ST PUMP ST.	209,579.89	0.00	0.00	0.00	209,579.89	209,579.89	0.00
#628 FIREHOUSE IMPROV	50,898.22	0.00	0.00	0.00	50,898.22	50,898.22	0.00
#634 STREET SWEEPER	0.00	0.00	0.00	0.00	0.00	0.00	0.00
#639 ROADS & SIDEWALK IMPROVEMENTS	0.00	0.00	0.00	0.00	0.00	0.00	0.00
#640 PRELIMINARY EXPENSE MUNICIPAL BLDG	10,429.37	0.00	0.00		10,429.37	10,429.37	0.00
#643 POLICE SPORTS UTILITIES VEHICLES	0.00	0.00	0.00	0.00	0.00	0.00	0.00
#644 VARIOUS CAPITAL IMPROVEMENTS	942.00	0.00	0.00	0.00	942.00	942.00	0.00
#654 BEACH PROTECTION	31,889.59	0.00	0.00	0.00	31,889.59	31,889.59	0.00
#655 CONSTR. MUNI BLDG	1,259,696.13	0.00	868.20	623,013.11	635,814.82	635,814.82	
#659 BEACH REPLEN.	82,928.89	0.00	10,409.75	2,347.19	70,171.95	70,171.95	
#658							

ORD #	BALANCE AS OF	2014 AUTH/	PAID	PAID TO		BAL	BAL
ORD NAME	1/1/2019	CANCELLED		DATE	BALANCE	FUNDED	UNFUNDED
VARIOUS CAP IMPROV	35,525.72	0.00	0.00	0.00	35,525.72	35,525.72	
TOTAL	1,950,425.11	0.00	91,591.26	566,869.09	1,279,618.53	1,279,618.53	0.00

BOROUGH OF MANTOLOKING

2018 RESERVE YEAR APPROPRIATIONS

FOR THE MONTH OF : AUGUST 31, 2019

<u>APPROP TITLE</u>	<u>2018 RESERVE BUDGET</u>	<u>EXPENDED YEAR TO DATE</u>	<u>ENCUMBERED</u>	<u>BALANCE</u>
MUNICIPAL CLERK				
SALARY & WAGES	1,100.95	0.00	0.00	1,100.95
OTHER EXPENSES	6,373.01	-402.93	0.00	6,775.94
FINANCE				
SALARY & WAGES	538.97	0.00	0.00	538.97
OTHER EXPENSES	9,541.20	-1,224.02	0.00	10,765.22
AUDITING				
OTHER EXPENSES	393.75	0.00	0.00	393.75
TAX COLLECTOR				
SALARY & WAGES	0.00	0.00	0.00	0.00
OTHER EXPENSES	654.26	0.00	0.00	654.26
TAX ASSESSOR				
SALARY & WAGES	156.97	0.00	0.00	156.97
OTHER EXPENSES	741.20	9.62	0.00	731.58
LEGAL				
OTHER EXPENSES	4,294.90	-10,000.00	0.00	14,294.90
LEGAL OE OUTSIDE CAP:	0.00	0.00	0.00	0.00
ENGINEERING				
OTHER EXPENSES	39,080.98	16,294.36	0.00	22,786.62
PLANNING				
SALARY & WAGES	2,486.40	0.00	0.00	2,486.40
OTHER EXPENSES	8,418.72	676.67	0.00	7,742.05
CONSTRUCTION				
SALARY & WAGES	1,372.09	0.00	0.00	1,372.09
CONSTRUCTION				
SALARY & WAGES O/S	0.00	0.00	0.00	0.00
OTHER EXPENSES	2,108.80	-1,563.60	0.00	3,672.40

BOROUGH OF MANTOLOKING

2018 RESERVE YEAR APPROPRIATIONS

FOR THE MONTH OF : AUGUST 31, 2019

<u>APPROP TITLE</u>	<u>2018 RESERVE BUDGET</u>	<u>EXPENDED YEAR TO DATE</u>	<u>ENCUMBERED</u>	<u>BALANCE</u>
PLUMBING SUB-CODE				
SALARY & WAGES	355.00	0.00	0.00	355.00
PLUMBING SUB-CODE				
SALARY & WAGE O/S	0.00	0.00	0.00	0.00
OTHER EXPENSES	0.00	0.00	0.00	0.00
FIRE SUB-CODE				
SALARY & WAGES	1,055.58	0.00	0.00	1,055.58
SALARY & WAGE O/S	0.00	0.00	0.00	0.00
OTHER EXPENSES	0.00	0.00	0.00	0.00
ELECTRICAL SUB-CODE				
SALARY & WAGES	1,882.50	0.00	0.00	1,882.50
SALARY & WAGES O/S	0.00	0.00	0.00	0.00
LIABILITY INS				
OTHER EXPENSES	3,669.62	0.00	0.00	3,669.62
WORKMENS COMP				
OTHER EXPENSES	0.00	0.00	0.00	0.00
GROUP HEALTH				
OTHER EXPENSES	30,590.96	11,750.00	0.00	18,840.96
O/S CAP	0.00	0.00	0.00	0.00
GROUP HLTH WAIVERS	0.00	0.00	0.00	0.00
POLICE				
SALARY & WAGES	19,754.36	0.00	0.00	19,754.36
OTHER EXPENSES	44,203.84	37,931.16	0.00	6,272.68
EMERG MNGMT				
SALARY & WAGE	0.00	0.00	0.00	0.00
EMERG MNGMT				
OTHER EXPENSES	3,170.58	0.00	0.00	3,170.58

BOROUGH OF MANTOLOKING

2018 RESERVE YEAR APPROPRIATIONS

FOR THE MONTH OF : AUGUST 31, 2019

<u>APPROP TITLE</u>	<u>2018 RESERVE BUDGET</u>	<u>EXPENDED YEAR TO DATE</u>	<u>ENCUMBERED</u>	<u>BALANCE</u>
FIRST AID				
OTHER EXPENSES	0.00	0.00	0.00	0.00
FIRE				
OTHER EXPENSES	13,000.00	13,000.00	0.00	0.00
UNIFORM FIRE SAFETY				
SALARY & WAGES	868.70	0.00	0.00	868.70
MUNICIPAL PROSECUTOR				
OTHER EXPENSES	500.00	0.00	0.00	500.00
ROAD REPAIR				
SALARY & WAGES	4,773.39	0.00	0.00	4,773.39
OTHER EXPENSES	29,044.15	21,174.86	0.00	7,869.29
O/S CAPS	0.00	0.00	0.00	0.00
GARBAGE				
OTHER EXPENSES	3,180.41	0.00	0.00	3,180.41
RECYCLING				
OTHER EXPENSES	0.00	0.00	0.00	0.00
BLDGS & GROUNDS				
OTHER EXPENSES	13,264.44	4,522.41	0.00	8,742.03
OTHER EXP O/S CAP	0.00	0.00	0.00	0.00
SEWER				
OTHER EXPENSES	15,546.57	10,251.97	0.00	5,294.60
BOARD OF HLTH				
SALARY & WAGES	0.00	0.00	0.00	0.00
DOG ACCOUNT				
OTHER EXPENSE	271.00	0.00	0.00	271.00
MUNICIPAL ALLIANCE				
OTHER EXPENSES	0.00	0.00	0.00	0.00

BOROUGH OF MANTOLOKING

2018 RESERVE YEAR APPROPRIATIONS

FOR THE MONTH OF : AUGUST 31, 2019

<u>APPROP TITLE</u>	<u>2018 RESERVE BUDGET</u>	<u>EXPENDED YEAR TO DATE</u>	<u>ENCUMBERED</u>	<u>BALANCE</u>
AID TO POINT HOSP OTHER EXPENSES	0.00	0.00	0.00	0.00
ADMIN OF BEACH ACCESS				
SALARY & WAGES	13,195.23	10,000.00	0.00	3,195.23
OTHER EXPENSES	4,984.54	1,875.00	0.00	3,109.54
BEACH MAINTENANCE				
OTHER EXPENSES	34,032.15	16,805.54	0.00	17,226.61
BEACH MAINT-O/CAP				
OTHER EXPENSES	0.00	0.00	0.00	0.00
PUBLIC EVENTS	0.00	0.00	0.00	0.00
UTILITIES:				
ELECTRIC	179.86	-596.77	0.00	776.63
TELEPHONE	1,030.89	0.00	0.00	1,030.89
WATER	831.82	328.18	0.00	503.64
FIRE HYDRANT	3,809.24	2,576.00	0.00	1,233.24
NATURAL GAS	222.73	-1,217.88	0.00	1,440.61
GASOLINE	8,042.16	6,298.58	0.00	1,743.58
GASOLINE O/S CAP	0.00	0.00	0.00	0.00
OC UTILITY AUTH	19,080.00	18,568.88	0.00	511.12
OTHER EXPENSES	0.00	0.00	0.00	0.00
DCRP	7,890.34	23.82	0.00	7,866.52
PERS	1,821.99	1,299.81	0.00	522.18
SOCIAL SECURITY	3,677.38	0.00	0.00	3,677.38
PFRS	512.78	0.00	0.00	512.78
JUDGEMENTS	0.00	0.00	0.00	0.00
GRANTS:				
ALCH REHAB	0.00	0.00	0.00	0.00
BODY ARMOR	0.00	0.00	0.00	0.00

BOROUGH OF MANTOLOKING

2018 RESERVE YEAR APPROPRIATIONS

FOR THE MONTH OF : AUGUST 31, 2019

<u>APPROP TITLE</u>	<u>2018 RESERVE BUDGET</u>	<u>EXPENDED YEAR TO DATE</u>	<u>ENCUMBERED</u>	<u>BALANCE</u>
RECYCLING TONNAGE	0.00	0.00	0.00	0.00
DRUNK DRIVING	0.00	0.00	0.00	0.00
CLEAN COMMUNITIES	0.00	0.00	0.00	0.00
FEMA-BEACH PUSH GRA	0.00	0.00	0.00	0.00
CLICK IT OR TICKET	0.00	0.00	0.00	0.00
MUNICIPAL COURT				
SALARY & WAGES	3,611.98	0.00	0.00	3,611.98
OTHER EXPENSES	3,779.74	119.25	0.00	3,660.49
PUBLIC DEFENDER				
OTHER EXPENSES	700.00	0.00	0.00	700.00
CIF- POLICE SUV				
OTHER EXPENSES	0.20	0.00	0.00	0.20
CIF- BOROUGH WEBSITE				
OTHER EXPENSES	12,000.00	0.00	0.00	12,000.00
CIF- FINGERPRINT				
OTHER EXPENSES	0.27	0.00	0.00	0.27
CIF- AVA EQUIPMENT				
OTHER EXPENSES	12,000.00	8,669.00	0.00	3,331.00
DEBT SERVICE:				
NOTE PRINCIPAL	0.00	0.00	0.00	0.00
NOTE INTEREST	0.00	0.00	0.00	0.00
BOND INTEREST	0.00	0.00	0.00	0.00
SPECIAL EMERGENCY	0.00	0.00	0.00	0.00
RESERVE FOR				
UNCOLLECTED TAX	0.00	0.00	0.00	0.00

BOROUGH OF MANTOLOKING

2018 RESERVE YEAR APPROPRIATIONS

FOR THE MONTH OF : AUGUST 31, 2019

<u>APPROP TITLE</u>	<u>2018 RESERVE BUDGET</u>	<u>EXPENDED YEAR TO DATE</u>	<u>ENCUMBERED</u>	<u>BALANCE</u>
GRAND TOTAL	393,796.60	167,169.91	0.00	226,626.69

BOROUGH OF MANTOLOKING

2019 CURRENT YEAR APPROPRIATIONS

AS OF AUGUST 31, 2019

<u>APPROP TITLE</u>	<u>2019 ADOPTED BUDGET</u>	<u>EXPENDED</u>	<u>ENCUMBERED</u>	<u>BALANCE</u>	<u>% EXPEND</u>
MUNICIPAL CLERK					
SALARY & WAGES	156,127.00	102,484.80	0.00	53,642.20	0.66
OTHER EXPENSES	103,726.00	54,890.72	8,489.52	40,345.76	0.61
FINANCE					
SALARY & WAGES	149,498.00	89,329.45	0.00	60,168.55	0.60
OTHER EXPENSES	55,550.00	28,509.04	773.71	26,267.25	0.53
AUDITING					
OTHER EXPENSES	32,000.00	24,100.00	3,300.00	4,600.00	0.86
TAX COLLECTOR					
SALARY & WAGES	0.00	0.00	0.00	0.00	0.00
OTHER EXPENSES	2,500.00	245.99	0.00	2,254.01	0.10
TAX ASSESSOR					
SALARY & WAGES	17,777.00	11,851.36	0.00	5,925.64	0.67
OTHER EXPENSES	3,125.00	418.13	274.00	2,432.87	0.22
LEGAL					
OTHER EXPENSES	167,000.00	112,305.11	35,000.00	19,694.89	0.88
OE-OUTSIDE CAPS	0.00	0.00	0.00	0.00	0.00
ENGINEERING					
OTHER EXPENSES	166,000.00	59,550.48	27,500.00	78,949.52	0.52
PLANNING					
SALARY & WAGES	39,465.00	29,056.97	0.00	10,408.03	0.74
OTHER EXPENSES	31,500.00	5,220.92	19,092.50	7,186.58	0.77
SW-OUTSIDE CAPS	0.00	0.00	0.00	0.00	0.00
CONSTRUCTION					
SALARY & WAGES	110,116.00	70,183.69	0.00	39,932.31	0.64
S&W-OUTSIDE CAPS	0.00	0.00	0.00	0.00	0.00
OTHER EXPENSES	16,500.00	6,635.21	1,540.91	8,323.88	0.50
PLUMBING SUB-CODE					
SALARY & WAGES	8,500.00	4,760.00	0.00	3,740.00	0.56
S&W-OUTSIDE CAPS	0.00	0.00	0.00	0.00	0.00

BOROUGH OF MANTOLOKING

2019 CURRENT YEAR APPROPRIATIONS

AS OF AUGUST 31, 2019

<u>APPROP TITLE</u>	<u>2019 ADOPTED BUDGET</u>	<u>EXPENDED</u>	<u>ENCUMBERED</u>	<u>BALANCE</u>	<u>% EXPEND</u>
FIRE SUB-CODE					
SALARY & WAGES	8,500.00	4,256.62	0.00	4,243.38	0.50
S&W-OUTSIDE CAPS	0.00	0.00	0.00	0.00	0.00
ELECTRICAL SUB-CODE					
SALARY & WAGES	8,500.00	4,821.25	0.00	3,678.75	0.57
S&W-OUTSIDE CAPS	0.00	0.00	0.00	0.00	0.00
LIABILITY INS					
OTHER EXPENSES	120,235.00	107,119.90	0.00	13,115.10	0.89
WORKMENS COMP					
OTHER EXPENSES	78,500.00	77,541.00	0.00	959.00	0.99
GROUP HEALTH					
OTHER EXPENSES	292,500.00	232,779.79	2,053.56	57,666.65	0.80
OUTSIDE CAPS	0.00	0.00	0.00	0.00	0.00
HEALTH WAIVERS	10,000.00	5,000.00	0.00	5,000.00	0.00
POLICE					
SALARY & WAGES	1,158,656.00	821,441.39	0.00	337,214.61	0.71
OTHER EXPENSES	124,075.00	77,612.19	4,061.61	42,401.20	0.66
EMERG MNGMT					
SALARY & WAGES	0.00	0.00	0.00	0.00	0.00
OTHER EXPENSES	6,000.00	596.16	521.70	4,882.14	0.19
FIRST AID					
OTHER EXPENSES	1,500.00	0.00	1,500.00	0.00	0.00
FIRE					
OTHER EXPENSES	26,000.00	0.00	13,000.00	13,000.00	0.50
UNIFORM FIRE SAFETY					
SALARY & WAGES	3,992.00	2,696.28	0.00	1,295.72	0.68
MUNICIPAL PROSECUTOR					
OTHER EXPENSES	6,000.00	3,850.00	550.00	1,600.00	0.73
ROAD REPAIR					
SALARY & WAGES	179,125.00	105,281.11	0.00	73,843.89	0.59
S&W-OUTSIDE	0.00	0.00	0.00	0.00	0.00
OTHER EXPENSES	61,850.00	7,871.95	651.92	53,326.13	0.14

BOROUGH OF MANTOLOKING

2019 CURRENT YEAR APPROPRIATIONS

AS OF AUGUST 31, 2019

<u>APPROP TITLE</u>	<u>2019 ADOPTED BUDGET</u>	<u>EXPENDED</u>	<u>ENCUMBERED</u>	<u>BALANCE</u>	<u>% EXPEND</u>
GARBAGE					
OTHER EXPENSES	141,525.00	94,315.61	0.00	47,209.39	0.67
BLDGS & GROUNDS					
OTHER EXPENSES	64,400.00	13,126.12	2,390.85	48,883.03	0.24
OE-OUTSIDE	0.00	0.00	0.00	0.00	0.00
SEWER					
OTHER EXPENSES	43,000.00	17,316.67	7.99	25,675.34	0.40
BOARD OF HLTH					
SALARY & WAGES	0.00	0.00	0.00	0.00	#DIV/0!
DOG ACCOUNT					
OTHER EXPENSES	4,000.00	2,400.00	329.00	1,271.00	0.68
MUNICIPAL ALLIANCE					
OTHER EXPENSES	0.00	0.00	0.00	0.00	0.00
AID TO POINT HOSP					
OTHER EXPENSES	0.00	0.00	0.00	0.00	0.00
ADMIN OF BEACH ACCESS					
SALARY & WAGES	194,114.00	117,733.84	0.00	76,380.16	0.00
OTHER EXPENSES	27,960.00	13,169.81	2,882.15	11,908.04	0.57
BEACH MAINTENANCE					
OTHER EXPENSES	131,000.00	64,163.37	0.00	66,836.63	0.49
BEACH MAINT-O/CAP					
OTHER EXPENSES	14,000.00	0.00	0.00	14,000.00	0.00
UTILITIES:					
ELECTRIC	42,500.00	26,045.76	0.00	16,454.24	0.61
TELEPHONE	27,500.00	17,671.13	342.21	9,486.66	0.66
WATER	3,000.00	2,715.04	0.00	284.96	0.91
FIRE HYDRANT	37,500.00	18,032.00	0.00	19,468.00	0.48
NATURAL GAS	20,000.00	7,726.33	0.00	12,273.67	0.39
GASOLINE	35,000.00	12,149.57	0.00	22,850.43	0.35
GASOLINE-OUTSIDE CAPS	0.00	0.00	0.00	0.00	0.00

BOROUGH OF MANTOLOKING

2019 CURRENT YEAR APPROPRIATIONS

AS OF AUGUST 31, 2019

<u>APPROP TITLE</u>	<u>2019 ADOPTED BUDGET</u>	<u>EXPENDED</u>	<u>ENCUMBERED</u>	<u>BALANCE</u>	<u>% EXPEND</u>
OC UTILITY AUTH OTHER EXPENSES	130,000.00	90,877.50	0.00	39,122.50	0.70
SICK LEAVE TRUST	35,000.00	0.00	0.00	35,000.00	0.00
PERS	62,557.00	59,369.50	0.00	3,187.50	0.95
SOCIAL SECURITY	99,500.00	59,375.72	0.00	40,124.28	0.60
PFRS	244,890.00	243,780.00	0.00	1,110.00	1.00
DCRP	10,000.00	1,115.91	0.00	8,884.09	0.11
UNEMPLOYMENT INSURANC	0.00	0.00	0.00	0.00	0.00
GRANTS:					
BODY ARMOR	1,683.00	0.00	0.00	1,683.00	0.00
RECYCLING TONNAGE	1,203.00	0.00	0.00	1,203.00	0.00
DRUNK DRIVING	0.00	0.00	0.00	0.00	0.00
CLEAN COMMUNITIES	4,000.00	0.00	0.00	4,000.00	0.00
DISTRACTED DRIVER GRANT	0.00	0.00	0.00	0.00	0.00
ALC REHAB	0.00	0.00	0.00	0.00	0.00
CLICK IT OR TICKET	0.00	0.00	0.00	0.00	0.00
2015 PEDESTRIAN SAFETY	0.00	0.00	0.00	0.00	0.00
DRIVE SOBER	0.00	0.00	0.00	0.00	0.00
NJ DOT TRUST	0.00	0.00	0.00	0.00	0.00
POLICE VEST GRANT	0.00	0.00	0.00	0.00	0.00
MUNICIPAL COURT					
SALARY & WAGES	41,420.00	26,420.00	0.00	15,000.00	0.64
OTHER EXPENSES	4,650.00	780.00	163.52	3,706.48	0.20
PUBLIC DEFENDER					
OTHER EXPENSES	1,000.00	0.00	0.00	1,000.00	0.00
CAPITAL IMPROVEMENT					
CAPITAL IMPR FUND	0.00	0.00	0.00	0.00	0.00
CIF-POLICE SUV	0.00	0.00	0.00	0.00	0.00
CIF-BEACH EQUIPMENT	27,500.00	21,863.86	5,629.50	6.64	0.00
CIF-POLICE ATV	0.00	0.00	0.00	0.00	0.00
CIF-BOROUGH WEBSITE	0.00	0.00	0.00	0.00	0.00
CIF-AUDIO VISUAL EQUIPMENT	0.00	0.00	0.00	0.00	0.00
BEACH REPLENISHMENT	0.00	0.00	0.00	0.00	0.00

BOROUGH OF MANTOLOKING

2019 CURRENT YEAR APPROPRIATIONS

AS OF AUGUST 31, 2019

<u>APPROP TITLE</u>	<u>2019 ADOPTED BUDGET</u>	<u>EXPENDED</u>	<u>ENCUMBERED</u>	<u>BALANCE</u>	<u>% EXPEND</u>
JUDGMENTS	40,000.00	11,945.00	0.00	28,055.00	0.00
DEBT SERVICE:					
BOND INTEREST	162,650.00	82,250.00	0.00	80,400.00	0.51
BOND PRINCIPAL	185,000.00	185,000.00	0.00	0.00	1.00
NOTE PRINCIPAL	0.00	0.00	0.00	0.00	0.00
NOTE INTEREST	0.00	0.00	0.00	0.00	0.00
DEFERRED CHARGES					
ORD 607	0.00	0.00	0.00	0.00	0.00
ORD 610	0.00	0.00	0.00	0.00	0.00
ORD 626	0.00	0.00	0.00	0.00	0.00
ORD 608	0.00	0.00	0.00	0.00	0.00
ORD 598			0.00	0.00	0.00
ORD 601			0.00	0.00	0.00
ORD 603			0.00	0.00	0.00
ORD 608			0.00	0.00	0.00
					0.00
5 YEAR EMERGENCY	0.00	0.00	0.00	0.00	0.00
RESERVE FOR UNCOLLECTED TAX	302,528.00	0.00	0.00	302,528.00	0.00
GRAND TOTAL	5,283,897.00	3,239,752.25	130,054.65	1,914,090.10	0.64

**BOROUGH OF MANTOLOKING
BILL LIST
October 15, 2019**

INVOICES PAID THROUGH THE MEETING

	<u>AMOUNT</u>
2018 CURRENT FUND RESERVE	0.00
2019 CURRENT FUND	1,655,040.05
ANIMAL CONTROL ACCOUNT	1.20
PAYROLL ACCOUNT	28,527.57
GENERAL CAPITAL	0.00
TRUST OTHER	0.00
UNEMPLOYMENT TRUST	0.00
DEVELOPERS TRUST	0.00
INSURANCE PROCEEDS-CURRENT FUND REVENUE	0.00
TOTAL ALL FUNDS	<u>1,683,568.82</u>

MANUAL CHECKS

<u>VENDOR</u>	<u>DATE</u>	<u>CK#</u>	<u>AMOUNT</u>
CAPITAL FUND - DESCHAMPS MATS SYSTEMS, INC.	9/20/2019	2853	6,057.00
CAPITAL FUND - DESCHAMPS MATS SYSTEMS, INC.	10/1/2019	2854	2,019.00
CURRENT FUND - BALLY'S ATLANTIC CITY	10/1/2019	31099	274.00
CURRENT FUND - GREAT AMERICAN LEASING	10/1/2019	31100	144.00
CURRENT FUND - JCP&L	10/1/2019	31101	2,997.41
CURRENT FUND - JCP&L STREET LIGHTING	10/1/2019	31102	739.54
CURRENT FUND - NJ NATURAL GAS	10/1/2019	31103	179.17
CURRENT FUND - VERIZON WIRELESS	10/1/2019	31104	401.59
CURRENT FUND - NEW JERSEY STATE LEAGUE	10/3/2019	31105	330.00
CURRENT FUND - TREASURER, STATE OF NEW JERSEY	10/3/2019	31106	25.00
PAYROLL FUND - AFLAC	9/18/2019	2349	654.21
PAYROLL FUND - SEPTEMBER 30, 2019 PAYROLL	9/30/2019	WIRE	88,511.43
TRUST FUND - MONTENEGRO, THOMPSON	9/18/2019	2684	1,143.33
TOTAL			<u>90,840.94</u>

GRAND TOTAL 1,774,409.76

P.O. Type: All

Open: N Paid: N Void: N
Rcvd: Y Held: Y Aprv: N
Bid: Y State: Y Other: Y Exempt: Y

Range: First to Last
Format: Condensed

PO #	PO Date	Vendor	PO Description	Status	Amount	Void Amount	PO Type
19-00215	03/05/19	W0053	WAGE WORKS	HEALTHCARE-BENEFIT 2019	Open	100.00	0.00 B
19-00279	03/19/19	B0109	BRAGEN-EDLY, JOY C.	RECYCLE COORDINATOR 2019	Open	437.50	0.00 B
19-00843	08/12/19	C0117	CEUnion	THE GOVERNMENT ETHICS SEMINAR	Open	95.00	0.00
19-00879	08/20/19	E0054	EDC ELECTRIC T/A ELETRICAL	SERVICE TO GENERATOR	Open	571.00	0.00
19-00892	08/29/19	O0057	OCEAN COUNTY POWERSPORTS	BEACH QUAD MAINTENANCE	Open	143.88	0.00
19-00893	08/29/19	W0068	WIRELESS ELECTRONICS, INC	POWER SUPPLY 12 VDC 110 VOLT	Open	255.00	0.00
19-00902	08/29/19	B0119	BOARDWALK 1000, LLC	HOTEL RESERVATION :FOR LEAGUE	Open	308.00	0.00
19-00907	09/04/19	D0054	DEPTCOR	4' DETAINING BENCH FOR POLICE	Open	549.00	0.00
19-00908	09/05/19	O0057	OCEAN COUNTY POWERSPORTS	MAINTENANCE ON BEACH VEHICLES	Open	1,504.29	0.00 B
19-00909	09/05/19	I0020	COLOSSUS, INC	MOBILE ICE/CAP NOV 19-OCT 20	Open	836.14	0.00
19-00922	09/06/19	P0071	POINT PLEASANT BEACH	POINT PLEAS BOE SEPT-DEC 2019	Open	9,280.90	0.00 B
19-00923	09/06/19	C0002	COSTCO COMPANY	SEPTEMBER 2019 SUPPLIES	Open	105.30	0.00
19-00925	09/10/19	M0136	MORGAN PRINTING SERVICE LLC	ENVELOPES & LETTERHEAD	Open	265.00	0.00
19-00926	09/10/19	M0027	MGL PRINTING SOLUTIONS	Notcies	Open	301.00	0.00
19-00927	09/10/19	W0059	WB MASON	SEPTEMBER SUPPLIES 2019	Open	218.55	0.00
19-00928	09/10/19	W0059	WB MASON	POLICE SUPPLIES SEPT 2019	Open	417.87	0.00
19-00931	09/11/19	L0010	NEW JERSEY STATE LEAGUE	LUNCHEON AND EVENT @ LEAGUE	Open	55.00	0.00
19-00933	09/11/19	M0107	MONTENEGRO, THOMPSON,	PLANNING BOARD AUG 2019	Open	105.00	0.00
19-00934	09/11/19	G0086	GUARDIAN TRACKING LLC	ANNUAL SOFTWARE ACCESS FOR POS	Open	1,202.00	0.00
19-00935	09/11/19	T0003	TIRE CRAFT, INC	VEH MAINT: PD VEHICLE # CHIEFS	Open	38.95	0.00
19-00936	09/11/19	A0007	ASBURY PARK PRESS, INC	ADVERTISEMENTS BOND ORD. 693	Open	70.52	0.00
19-00937	09/11/19	V012	VAN WICKLE AUTO SUPPLY	SUPPLIES	Open	7.80	0.00
19-00938	09/11/19	B0114	B SAFE, INC.	INSPECTION/FIRE MONITORING	Open	733.02	0.00
19-00939	09/11/19	A0199	AT&T	OEM LONG DISTANCE 09/01-9/30	Open	3.96	0.00
19-00941	09/11/19	J0054	JERSEY DELIVERY SERVICE, INC	NOT APPROVED STICKERS	Open	159.00	0.00
19-00943	09/12/19	M0152	MILSPRAY	VEHICLE MAINTENANCE	Open	197.00	0.00
19-00944	09/12/19	J0025	JAEGER LUMBER	SUPPLIES	Open	32.98	0.00
19-00945	09/12/19	B0001	BEAVER DAM HARDWARE, INC	SUPPLIES	Open	2.76	0.00
19-00946	09/12/19	T0009	TCTA of NJ	TCTA OF NJ BREAKFAST SEMINAR	Open	25.00	0.00
19-00948	09/12/19	L0030	LOWES LAR ACCOUNT	POWER WASHER - SUPPLIES	Open	223.70	0.00
19-00949	09/12/19	C0133	CANON SOLUTIONS AMERICA, INC.	MONTHLY PRINTER SEPTEMBER 2019	Open	809.54	0.00
19-00950	09/12/19	D0054	DEPTCOR	BL THERMAL BLANKETS	Open	255.00	0.00
19-00951	09/12/19	B0042	BOLLINGER, INC. - DENTAL	DENTAL PREMIUM 10/2019	Open	1,840.20	0.00
19-00952	09/13/19	M0110	MANTOLOKING SUI ACCOUNT	P/R TAXES FOR UNEMPLOYMENT	Open	9,000.00	0.00
19-00953	09/16/19	F0023	FERGUSON ENTERPRISES, INC.	TABS	Open	115.98	0.00
19-00954	09/16/19	R0063	RICCORDI'S BROTHERS	PAINT	Open	120.94	0.00
19-00955	09/16/19	E0039	EAGLE POINT GUN	AMMUNITION	Open	6,325.23	0.00
19-00957	09/17/19	C0118	COMCAST - XFINITY	TELEPHONE SERVICE 09/13-10/14	Open	489.14	0.00
19-00958	09/17/19	W0066	WINDSTREAM COMMUNICATIONS LLC	TELEPHONE(BH & PD) 9/10-10/09	Open	795.15	0.00
19-00959	09/17/19	E0012	EXECUTIVE COMPUTER SYS., INC.	BACK UP BATTERY (BOILER ROOM)	Open	109.00	0.00
19-00960	09/17/19	L0061	BOROUGH OF LAVALLETT	MONTHLY LEASE OCTOBER 2019	Open	640.00	0.00
19-00961	09/17/19	N0035	NEW ERA CAR WASH	CASH WASHES AUGUST 2019	Open	21.00	0.00
19-00962	09/17/19	T0003	TIRE CRAFT, INC	VEH MAINT: PD VEHICLE 1904	Open	64.56	0.00
19-00964	09/17/19	A0207	APRIL YEZZI	REIMBRUSEMENT ON FINANCE GUIDE	Open	133.26	0.00
19-00965	09/17/19	I0018	INTERNATIONAL CODE COUNCIL INC	CONSTRUCTION CODE BOOKS	Open	235.00	0.00
19-00966	09/17/19	V012	VAN WICKLE AUTO SUPPLY	SUPPLIES	Open	26.28	0.00
19-00971	09/19/19	A0215	AMAZON.COM SERVICES, INC.	CABINET MAGENTS AND PAPER	Open	66.48	0.00
19-00973	09/19/19	W0062	WHITE, E. LAURENCE	REIMBURSE FOR FALL MEETING	Open	30.00	0.00
19-00974	09/19/19	E0012	EXECUTIVE COMPUTER SYS., INC.	SERVICE ON OEM LAPTOP	Open	160.50	0.00
19-00975	09/19/19	T0003	TIRE CRAFT, INC	VEH MAINT: PD VEHICLE # 1901	Open	94.95	0.00

PO #	PO Date	Vendor	PO Description	Status	Amount	Void Amount	PO Type	
19-00976	09/19/19	C0131	COAST BUICK INC	VEH MAINT: PD VEHICLE	Open	359.04	0.00	
19-00977	09/19/19	B0001	BEAVER DAM HARDWARE, INC	AQUAPHALT 4.0 50LBS	Open	54.99	0.00	
19-00978	09/19/19	W0028	WATCHUNG SPRING WATER	WATER DELIVERY 8/15-9/11	Open	707.29	0.00	
19-00979	09/19/19	T0002	THE COAST STAR NEWSPAPERS	LEGALS ADS FOR 09/2019	Open	177.40	0.00	
19-00982	09/19/19	J0052	JPMONZO, MUNICIPAL CONSULTING	BEST PRACTICE INVENTORY WEBINA	Open	50.00	0.00	
19-00983	09/19/19	T0018	TROPICANA CASINO & RESORT	HOTEL RESERVATION	Open	244.00	0.00	
19-00985	09/20/19	N0051	NJ DEPT OF HLTH & SR SERVICES	DOG LICENSE FEES 2Q/3Q 2019	Open	1.20	0.00	
19-00988	09/26/19	C0118	COMCAST - XFINITY	PD FAX/MODEM LINES 09/21-10/20	Open	174.85	0.00	
19-00989	09/26/19	N0004	VERIZON	OEM ALARM 09/13-10/12	Open	160.13	0.00	
19-00991	09/26/19	P0066	PETERSON, BONNIE	INVOICE FOR SEPTEMBER 2019	Open	550.00	0.00	
19-00992	09/26/19	R0058	REPUBLIC SERVICES, INC	RESIDENTIAL SERVICE 10/1-10/31	Open	11,921.17	0.00	
19-00993	09/26/19	T0003	TIRE CRAFT, INC	VEH MAINT: PD VEHICLE 1904	Open	730.50	0.00	
19-00994	09/26/19	C0002	COSTCO COMPANY	SEPTEMBER 2019 SUPPLIES	Open	353.93	0.00	
19-00995	09/26/19	V012	VAN WICKLE AUTO SUPPLY	FUEL FILTER	Open	8.58	0.00	
19-00996	09/26/19	A0204	AMANJ C/O LIZ SIMPKINS, CTA	ASSESSORS LUNCHEON MEETING	Open	60.00	0.00	
19-00999	09/27/19	P0054	MANTOLOKING POLICE ASSOCIATION	POLICE DUES 3 Q 2019	Open	1,200.00	0.00	
19-01000	09/27/19	M0001	MANTOLOKING CURRENT FUND	MED & DEN REIMBURSE 3 Q 3019	Open	26,273.36	0.00	
19-01001	09/27/19	E0026	EQUITABLE	DEFERRED COMP AUG & SEPT 2019	Open	400.00	0.00	
19-01002	09/27/19	K0021	KONOPADA, BEVERLEY ANN	REIMBURSEMENTS SUPPLY/NOTARY	Open	49.71	0.00	
19-01006	10/01/19	E0012	EXECUTIVE COMPUTER SYS., INC.	SERVICE ON SITE 09/20/19	Open	340.50	0.00	
19-01007	10/01/19	A0053	AFLAC - CV190	AFLAC PREMIUMS SEPTEMBER 2019	Open	654.21	0.00	
19-01008	10/01/19	J0044	JCP&L - MASTER BILL ACCT	MASTER ACCOUNT 08/17-09/17/19	Open	227.09	0.00	
19-01009	10/02/19	00002	OCEAN COUNTY UTILITY AUTHORITY	FOURTH QUARTER 2019 PAYMENT	Open	30,292.50	0.00	
19-01010	10/02/19	C0094	CERTIFIED SPEEDOMETER SERVICE	VEHICLES CALIBRATED FOR PD	Open	195.00	0.00	
19-01013	10/02/19	T0078	TREASURER, ST OF NJ	STATE TRAINING FEES 3Q 2019	Open	3,286.00	0.00	
19-01014	10/02/19	J0057	JOHNNY ON THE SPOT A DBA	EXTRA-ON CALL SERVICE LAYMAN	Open	70.00	0.00	
19-01016	10/02/19	R0060	ROTHSTEIN, MANDELL, STROHM	LEGAL SERVICE 09-2019	Open	13,699.50	0.00	
19-01017	10/03/19	T0003	TIRE CRAFT, INC	VEH MAINT: PD VEHICLES	Open	2,387.72	0.00	
19-01018	10/03/19	00013	OSPREY TECHNOLOGY	MONTHLY WEBSITE MAINT: 09/2019	Open	140.00	0.00	
19-01020	10/03/19	00010	OCEAN COUNTY - TAXES	4TH QUARTER TAXES 2019	Open	1,548,221.32	0.00	
19-01021	10/03/19	E0012	EXECUTIVE COMPUTER SYS., INC.	MONTHLY MAINTENANCE 10-2019	Open	575.00	0.00	
19-01022	10/03/19	E0012	EXECUTIVE COMPUTER SYS., INC.	SERVICE ON-SITE 10/02/2019	Open	126.50	0.00	
19-01023	10/03/19	M0144	MUSKRAT JACK ANIMAL SERVICES	ANIMAL CONTROL OCT 2019	Open	300.00	0.00	
Total Purchase Orders:		83	Total P.O. Line Items:	0	Total List Amount:	1,683,568.82	Total Void Amount:	0.00

Totals by Year-Fund		Budget Rcvd	Budget Held	Budget Total	Revenue Total	G/L Total	Total
Fund Description	Fund						
CURRENT FUND	9-01	1,655,040.05	0.00	1,655,040.05	0.00	0.00	1,655,040.05
	9-12	1.20	0.00	1.20	0.00	0.00	1.20
	9-14	28,527.57	0.00	28,527.57	0.00	0.00	28,527.57
Total of All Funds:		<u>1,683,568.82</u>	<u>0.00</u>	<u>1,683,568.82</u>	<u>0.00</u>	<u>0.00</u>	<u>1,683,568.82</u>

Phone (732) 295-1401



Fax (732) 295-1469

MANTOLOKING POLICE DEPARTMENT

Chief of Police
Stacy S. Ferris

10/04/2019

Mayor & Council

Please accept the following as the monthly report for the Mantoloking Police Department.

Dispatch:

- 1 Driving under the influence arrests, 1 CDS arrest & 1 drug arrest
- 1 Motor vehicle theft, 2 First aid calls & 1 verbal dispute
- 13 Alarms, 7 Borough Ord. Violations, 2 motor vehicle accidents
- 3 suspicious conditions / persons, 14 agency assists

****The above is a just some of the calls responded to****

Special Alerts

- ❖ **Speed limit will be going back up to 40 MPH in or around October 1st**
- ❖ **Bergen & Lyman traffic lights will be taken off of cycle and placed on blink on or around October 1st please stay alert.**
- ❖ **If you are leaving for the season please email policeservices@mantoloking.org to be added to our away list.**
- ❖ **Please update or fill out "We Care Forms" with special attention to Power dependent (O2) residents, care takers, cameras, guns and alarms. Forms can be located on the Borough website under the police tab or at the police department.**

Directed Patrols:

- ❖ Vehicles on the beach
- ❖ Speeding Barnegat Lane
- ❖ Wrong way on East Ave
- ❖ Construction activity before 8AM

Beach Report:

- As we start looking back on the 2019 beach season, I ask that anyone who would like to share a positive or negative experience or have any comments or suggestions about the beach to please forward them to me at ferris@mantoloking.org title – beach19.
- Applications for the 2020 summer season are available at the Police window for seasonal employment Monday thru Thursday 9:30 to 4PM. We are looking for Sellers, Checkers and lifeguards. Applicants must be 17 years or older.

Contact Information for the Police Department:

- 732-295-1465 is the 24 hour phone number to the police department. It is manned by the Ocean County Sheriff's Department. This is for non-emergency calls, for example; animals, parking and noise complaints. 911 is for all emergency calls.
- 732-295-1401 is the inside administration line that is manned from 9 AM to 4 PM, Monday thru Friday.

Fleet Status:

#	Year	Make / Model	Mileage	Mechanical / Logistics	Primary Use	
1900	2017	Ford / Explorer	7,924		Chief	
1901	2011	Chevy / Tahoe	68,482	Unmarked	Fleet / Admin	A & B Day Specials
1902	2015	Chevy/ Tahoe	79,989	Dash board camera	Patrol	A & B Afternoon
1903	2013	Chevy / Silverado	56,905		Beach	Beach & road job
1904	2015	Chevy/Tahoe	79,227	Dash board camera	Patrol	A & B Squad day
1905	2016	Chevy / Caprice	74,865	Dash board camera	Patrol	A & B night Specials
1906	2017	Chevy/ Tahoe	45,583	Dash board camera	Patrol	A & B Afternoons
1908	2018	Chevy / Tahoe	32,327	Dash board camera	Patrol	A & B Squad night
1909	1995	Safe Boat		Saturday & Sunday	Summer	
1914	2018	Polaris Ranger XP 1000			Beach	
1916 & 1922	2012	2- ATV		1 lifeguard / 1 patrol	Beach	7 days

Respectfully submitted,

Chief Stacy Ferris



MANTOLOKING FIRE COMPANY No. 1

Serving the
Borough of Mantoloking
Downer Avenue
P.O. Box 213

Mantoloking, New Jersey 08738

10/3/19

Mayor & Council

During the month of September 2019 the Mantoloking Fire Company responded to 16 fire calls, held 2 drills and held our regularly scheduled business meeting. The table below provides a list of the calls for the month.

Date	Time	Location	Town	Incident Type
9/5/19	19:06	1104 Barnegat Lane	Mantoloking	Fire Alarm
9/5/19	19:09	Karge Beach	Bay Head	Water Rescue
9/7/19	14:37	Egbert Beach	Bay Head	Water Rescue
9/8/19	09:19	512 Main Ave.	Bay Head	Fire Alarm
9/8/19	14:50	442 Main Ave.	Bay Head	Fire Alarm
9/9/19	13:53	1014 Barnegat Lane	Mantoloking	Mulch Fire
9/12/19	12:14	1308 Bay Ave	Mantoloking	Fire Alarm
9/13/19	14:34	1325 Ocean Ave.	Mantoloking	Fire Alarm
9/14/19	09:05	29 Karge St.	Bay Head	Odor Invest
9/16/19	19:26	179 Bridge Ave.	Bay Head	Odor Invest
9/17/19	13:35	425 East Ave.	Bay Head	Co Alarm
9/20/19	14:17	41 Mount St.	Bay Head	Fire Alarm
9/24/19	19:11	160 Osborne Ave.	Bay Head	Fire Alarm
9/27/19	10:28	854 Clayton Ave	Bay Head	Fire Alarm
9/28/19	09:19	210 Channel Lane	Mantoloking	Fire Alarm
9/30/19	07:22	970 East Ave.	Mantoloking	Fire Alarm

Submitted By, Asst. Chief Scott Hulse



BOROUGH of MANTOLOKING
DEPARTMENT OF PUBLIC WORKS
203 Downer Ave., Mantoloking, NJ 08738
PHONE: 732-801-8298 FAX: 732-295-1465



DATE: 10/3/19

Mayor and Council

Listed below are the tasks undertaken by DPW during the month of September 2019.

1. Packed up and put away lifeguard equipment.
2. Removed and cleaned access mats at Downer walkway.
3. Painted and Organized connex box in DPW yard.
4. Removed warning signs from beach and reinstalled at walkway entrances.
5. Took down Porta John enclosures
6. Cleaned storm debris from storm drains.
7. Repaired Princeton vehicle access
8. Made and installed signs for motor vehicle accesses.
9. Installed fencing at DPW yard.
10. Reorganized DPW yard.
11. Started power washing and painting fire house.
12. Swept streets
13. Multiple mark outs.
14. Took all beach ATV's for end of summer maintenance.
15. Changed Urinal Cartridge in police bathroom
16. Hung pictures in Boro Hall.
17. Had furnaces at DPW garage serviced.
18. Repaired hydraulic lines on dump truck.
19. Repaired potholes throughout town.
20. Worked with BTMUA cleaning sewer lines.
21. Assisted contractor with balancing report.

Submitted By,

Scott Hulse

OFFICE OF CONSTRUCTION OFFICIAL

Construction Permit Activity Report

RANGE: 09/01/2019 To 09/30/2019

September 30, 2019 2:32:44PM

SUMMARY

CONSTRUCTION COSTS

COUNT

Cost Of Construction:	\$2,590,068.00	Cubic Footage:	161371 Cu.ft	Permit Issued:	14
Cost Of Alteration:	\$695,200.00	Square Footage:	5944 Sq.ft	Updates Issued:	7
Cost Of Demolition:	\$0.00			All Fees Waived:	2
Total Cost:	\$3,285,268.00			Municipal Fees Waived:	0

<u>PERMIT FEES</u>		<u>ADMIN FEES</u>		<u>WAIVED FEES</u>		<u>TOTAL FEES</u>	
Building:	\$25,538.00	Building:	\$0.00	Building:	\$0.00	Building Fees:	\$25,538.00
Electrical:	\$900.00	Electrical:	\$0.00	Electrical:	\$0.00	Electrical Fees:	\$900.00
Fire :	\$250.00	Fire :	\$0.00	Fire :	\$0.00	Fire Fees:	\$250.00
Plumbing:	\$1,830.00	Plumbing:	\$0.00	Plumbing:	\$0.00	Plumbing Fees:	\$1,830.00
Elevator:	\$289.00	Elevator:	\$0.00	Elevator:	\$289.00	Elevator Fees:	\$0.00
Mechanical:	\$0.00	Mechanical:	\$0.00	Mechanical:	\$0.00	Mechanical Fees:	\$0.00
				* Total Waived:	\$289.00	Technical Fees:	\$28,518.00

<u>DCA</u>	Calculated Fees	Waived Fees	Collected Fees
Volume Training Fee:	\$599.00	\$0.00	\$599.00
Alteration Training Fee:	\$1,329.00	\$0.00	\$1,329.00
DCA Minimum Fee:	\$0.00	\$0.00	\$0.00
Sub total Training Fee:	\$1,928.00	\$0.00	\$1,928.00

TECHNICAL ISSUES

Building Technical:	6
Electrical Technical:	10
Fire Protection Technical:	3
Plumbing Technical:	7
Elevator Technical:	2
Mechanical Technical:	

Certificate of Occupancy Fee:	\$150.00
Waived Certificate Fees:	\$0.00
Sub Total Certificate Fees:	\$150.00

CERTIFICATE ISSUES

Certificate of Occupancy:	2
Certificate of Approval:	11
Certificate of Continued Occupancy:	0

PERMIT FEES:	\$28,518.00
FEES:	\$1,928.00
CERTIFICATE FEES:	\$150.00
MIN FEES:	\$0.00
NET TOTAL FEES:	\$30,596.00
PENALTIES COLLECTED:	\$0.00
CCO FEES:	\$0.00
OTHER FEES:	\$0.00
GRAND TOTAL FEES:	\$30,596.00

* By State law (see N.J.S. 52:27D-126c): \$289.00
 * By Municipality (see N.J.S. 52:27D-126b): \$0.00

OFFICE OF CONSTRUCTION OFFICIAL

Mantoloking

Permit Activity Report

Range From 09/01/2019 To 09/30/2019

September 30, 2019 2:32:46PM

Permit #	Permit Date	Census	Control #	Updates	Description Of Work										DCA Min.
					Block & Lot	Costs	Use Group	Waived Fees	Bldg	Elec	Fire	Plmb	Elev	Mech	
Work Site					Eadm	Fadm	Fadm	Padm	VAdm	MAdm	VolFee	CcoFee	Square Feet		
Owner Name		Minimum Fees	Btotl		Etotl	Ftotl	Ptotl	Vtotl	Mtotl	TFTotl	CertTotl	Total Fee			
20190082	9/4/2019	434	7187	0	Temporary Service										
14 8.03		\$500.00	R-5(R-5)		\$75.00	\$0.00	\$0.00	\$0.00	\$0.00	\$0.00	\$1.00	\$0.00			
916 Ocean Avenue					\$0.00	\$0.00	\$0.00	\$0.00	\$0.00	\$0.00	\$0.00	\$0.00			
Coastal Equities LLC					\$75.00	\$0.00	\$0.00	\$0.00	\$0.00	\$0.00	\$1.00	\$0.00			
20190058	9/5/2019	434	7176	1	Deck										
24 11		\$10,000.00	U		\$300.00	\$0.00	\$0.00	\$0.00	\$0.00	\$0.00	\$19.00	\$0.00			
1039 Barnegat Lane					\$0.00	\$0.00	\$0.00	\$0.00	\$0.00	\$0.00	\$0.00	\$0.00			
Dolan, Moira					\$300.00	\$0.00	\$0.00	\$0.00	\$0.00	\$0.00	\$19.00	\$0.00			
20180085	9/6/2019	101	7179	2	BURGLAR ALARM, Fire Alarm										
23 30		\$13,313.00	R-5		\$75.00	\$100.00	\$0.00	\$0.00	\$0.00	\$0.00	\$0.00	\$0.00			
1079 Ocean					\$0.00	\$0.00	\$0.00	\$0.00	\$0.00	\$0.00	\$0.00	\$0.00			
Dreaming on Ocean LLC					\$75.00	\$100.00	\$0.00	\$0.00	\$0.00	\$0.00	\$0.00	\$175.00			
20180085	9/6/2019	101	7188	4	Plumbing for New Home										
23 30		\$50,000.00	R-5		\$0.00	\$0.00	\$1,285.00	\$0.00	\$0.00	\$0.00	\$0.00	\$0.00			
1079 Ocean					\$0.00	\$0.00	\$0.00	\$0.00	\$0.00	\$0.00	\$0.00	\$0.00			
Dreaming on Ocean LLC					\$0.00	\$0.00	\$1,285.00	\$0.00	\$0.00	\$0.00	\$0.00	\$1,285.00			
20190026	9/9/2019	434	7178	1	Deck										
19 1		\$30,000.00	U		\$900.00	\$0.00	\$0.00	\$0.00	\$0.00	\$0.00	\$57.00	\$0.00			
219 Channel Lane					\$0.00	\$0.00	\$0.00	\$0.00	\$0.00	\$0.00	\$0.00	\$0.00			
Snyder, John & Harriet					\$900.00	\$0.00	\$0.00	\$0.00	\$0.00	\$0.00	\$57.00	\$0.00			
20190083	9/10/2019	434	7193	0	Temporary Tent Lighting										
30 6		\$100.00	R-5		\$0.00	\$75.00	\$0.00	\$0.00	\$0.00	\$0.00	\$1.00	\$0.00			
1224-1234 BAY AVENUE					\$0.00	\$0.00	\$0.00	\$0.00	\$0.00	\$0.00	\$0.00	\$0.00			
MANTOLOKING YACHT CLUB					\$75.00	\$0.00	\$0.00	\$0.00	\$0.00	\$0.00	\$1.00	\$0.00			
20190084	9/10/2019	434	7194	0	Temporary Tent Lighting										
30 6		\$100.00	R-5		\$0.00	\$75.00	\$0.00	\$0.00	\$0.00	\$0.00	\$1.00	\$0.00			
1224-1234 BAY AVENUE					\$0.00	\$0.00	\$0.00	\$0.00	\$0.00	\$0.00	\$0.00	\$0.00			
MANTOLOKING YACHT CLUB					\$75.00	\$0.00	\$0.00	\$0.00	\$0.00	\$0.00	\$1.00	\$0.00			
20190084	9/10/2019	434	7194	0	Temporary Tent Lighting										
30 6		\$100.00	R-5		\$0.00	\$75.00	\$0.00	\$0.00	\$0.00	\$0.00	\$1.00	\$0.00			
1224-1234 BAY AVENUE					\$0.00	\$0.00	\$0.00	\$0.00	\$0.00	\$0.00	\$0.00	\$0.00			
MANTOLOKING YACHT CLUB					\$75.00	\$0.00	\$0.00	\$0.00	\$0.00	\$0.00	\$1.00	\$0.00			

Permit #	Permit Date	Census	Control #	Updates		Description Of Work										CertTotl	Total Fee									
				Use Group	Bldg	Elec	Fire	Plmb	Elev	Mech	AltFee	CoFee	Cubic Feet	Costs	Waived Fees			Badm	Etotl	Ftotl	Ptotl	Vtotl	Mtotl	TFTotl	VolFee	Square Feet
Block & Lot	Work Site	Owner Name	Minimum Fees	Btotl	Etotl	Ftotl	Ptotl	Vtotl	Mtotl	TFTotl	VolFee	Square Feet	CoFee	Cubic Feet	Costs	Waived Fees	Badm	Etotl	Ftotl	Ptotl	Vtotl	Mtotl	TFTotl	VolFee	Square Feet	
23 49	9/11/2019	101	7185	0	New Single-Family																					
1117 OCEAN AVENUE		\$3,000,000.00	R-5	\$20,648.00	\$0.00	\$0.00	\$0.00	\$0.00	\$0.00	\$0.00	\$0.00	\$0.00	\$0.00	\$0.00	\$0.00	\$0.00	\$0.00	\$0.00	\$0.00	\$0.00	\$0.00	\$0.00	\$950.00	\$150.00	161,371.00	5,944.00
22 47	9/16/2019	101	7207	\$20,648.00	\$0.00	\$0.00	\$0.00	\$0.00	\$0.00	\$0.00	\$0.00	\$0.00	\$0.00	\$0.00	\$0.00	\$0.00	\$0.00	\$0.00	\$0.00	\$0.00	\$0.00	\$0.00	\$1,549.00	\$150.00	\$22,347.00	All Fees Wvd
1110 BARNEGAT		\$0.00	R-5	\$46.00	\$0.00	\$0.00	\$0.00	\$0.00	\$0.00	\$0.00	\$0.00	\$0.00	\$0.00	\$0.00	\$0.00	\$0.00	\$0.00	\$0.00	\$0.00	\$0.00	\$0.00	\$0.00	\$0.00	\$0.00	\$0.00	\$0.00
Mosca, Grace & Randall	9/18/2019	434	7195	\$0.00	\$0.00	\$0.00	\$0.00	\$0.00	\$0.00	\$0.00	\$0.00	\$0.00	\$0.00	\$0.00	\$0.00	\$0.00	\$0.00	\$0.00	\$0.00	\$0.00	\$0.00	\$0.00	\$0.00	\$0.00	\$0.00	\$0.00
23 16	9/16/2019	101	7207	\$2,550.00	\$115.00	\$0.00	\$0.00	\$0.00	\$0.00	\$0.00	\$0.00	\$0.00	\$0.00	\$0.00	\$0.00	\$0.00	\$0.00	\$0.00	\$0.00	\$0.00	\$0.00	\$0.00	\$168.00	\$0.00	\$0.00	\$0.00
1051 OCEAN AVE		\$88,000.00	U	\$0.00	\$0.00	\$0.00	\$0.00	\$0.00	\$0.00	\$0.00	\$0.00	\$0.00	\$0.00	\$0.00	\$0.00	\$0.00	\$0.00	\$0.00	\$0.00	\$0.00	\$0.00	\$0.00	\$0.00	\$0.00	\$0.00	\$0.00
Guller, Robert	9/18/2019	434	7204	\$2,550.00	\$115.00	\$0.00	\$0.00	\$0.00	\$0.00	\$0.00	\$0.00	\$0.00	\$0.00	\$0.00	\$0.00	\$0.00	\$0.00	\$0.00	\$0.00	\$0.00	\$0.00	\$0.00	\$168.00	\$0.00	\$2,908.00	
6 7	9/19/2019	101	7089	\$0.00	\$0.00	\$0.00	\$0.00	\$0.00	\$0.00	\$0.00	\$0.00	\$0.00	\$0.00	\$0.00	\$0.00	\$0.00	\$0.00	\$0.00	\$0.00	\$0.00	\$0.00	\$0.00	\$0.00	\$0.00	\$0.00	\$0.00
1012 EAST AVE		\$15,000.00	R-5	\$0.00	\$0.00	\$0.00	\$0.00	\$0.00	\$0.00	\$0.00	\$0.00	\$0.00	\$0.00	\$0.00	\$0.00	\$0.00	\$0.00	\$0.00	\$0.00	\$0.00	\$0.00	\$0.00	\$0.00	\$0.00	\$0.00	\$0.00
Benz, Charles & Hood, Barbara	9/19/2019	101	7089	\$0.00	\$0.00	\$0.00	\$0.00	\$0.00	\$0.00	\$0.00	\$0.00	\$0.00	\$0.00	\$0.00	\$0.00	\$0.00	\$0.00	\$0.00	\$0.00	\$0.00	\$0.00	\$0.00	\$0.00	\$0.00	\$0.00	\$0.00
21 25	9/20/2019	434	7202	\$0.00	\$0.00	\$0.00	\$0.00	\$0.00	\$0.00	\$0.00	\$0.00	\$0.00	\$0.00	\$0.00	\$0.00	\$0.00	\$0.00	\$0.00	\$0.00	\$0.00	\$0.00	\$0.00	\$0.00	\$0.00	\$0.00	\$0.00
988 Barnezat Lane		\$19,005.00	R-5	\$243.00	\$0.00	\$0.00	\$0.00	\$0.00	\$0.00	\$0.00	\$0.00	\$0.00	\$0.00	\$0.00	\$0.00	\$0.00	\$0.00	\$0.00	\$0.00	\$0.00	\$0.00	\$0.00	\$0.00	\$0.00	\$0.00	\$0.00
Beck, Christine	9/20/2019	434	7202	\$0.00	\$0.00	\$0.00	\$0.00	\$0.00	\$0.00	\$0.00	\$0.00	\$0.00	\$0.00	\$0.00	\$0.00	\$0.00	\$0.00	\$0.00	\$0.00	\$0.00	\$0.00	\$0.00	\$0.00	\$0.00	\$0.00	\$0.00
2 2	9/20/2019	434	7202	\$0.00	\$0.00	\$0.00	\$0.00	\$0.00	\$0.00	\$0.00	\$0.00	\$0.00	\$0.00	\$0.00	\$0.00	\$0.00	\$0.00	\$0.00	\$0.00	\$0.00	\$0.00	\$0.00	\$0.00	\$0.00	\$0.00	\$0.00
919 EAST AVE		\$7,500.00	R-5	\$0.00	\$0.00	\$0.00	\$0.00	\$0.00	\$0.00	\$0.00	\$0.00	\$0.00	\$0.00	\$0.00	\$0.00	\$0.00	\$0.00	\$0.00	\$0.00	\$0.00	\$0.00	\$0.00	\$0.00	\$0.00	\$0.00	\$0.00
BECKER, MICHAEL & KATHERINE	9/20/2019	434	7200	\$0.00	\$0.00	\$0.00	\$0.00	\$0.00	\$0.00	\$0.00	\$0.00	\$0.00	\$0.00	\$0.00	\$0.00	\$0.00	\$0.00	\$0.00	\$0.00	\$0.00	\$0.00	\$0.00	\$0.00	\$0.00	\$0.00	\$0.00
13 3	9/20/2019	434	7200	\$0.00	\$0.00	\$0.00	\$0.00	\$0.00	\$0.00	\$0.00	\$0.00	\$0.00	\$0.00	\$0.00	\$0.00	\$0.00	\$0.00	\$0.00	\$0.00	\$0.00	\$0.00	\$0.00	\$0.00	\$0.00	\$0.00	\$0.00
934 OCEAN AVENUE		\$650.00	R-5	\$0.00	\$0.00	\$0.00	\$0.00	\$0.00	\$0.00	\$0.00	\$0.00	\$0.00	\$0.00	\$0.00	\$0.00	\$0.00	\$0.00	\$0.00	\$0.00	\$0.00	\$0.00	\$0.00	\$0.00	\$0.00	\$0.00	\$0.00
Saier, Scott & Diana	9/20/2019	434	7198	\$0.00	\$0.00	\$0.00	\$0.00	\$0.00	\$0.00	\$0.00	\$0.00	\$0.00	\$0.00	\$0.00	\$0.00	\$0.00	\$0.00	\$0.00	\$0.00	\$0.00	\$0.00	\$0.00	\$0.00	\$0.00	\$0.00	\$0.00
13 11	9/20/2019	434	7198	\$0.00	\$0.00	\$0.00	\$0.00	\$0.00	\$0.00	\$0.00	\$0.00	\$0.00	\$0.00	\$0.00	\$0.00	\$0.00	\$0.00	\$0.00	\$0.00	\$0.00	\$0.00	\$0.00	\$0.00	\$0.00	\$0.00	\$0.00
965 Barnezat Lane		\$300.00	R-5	\$0.00	\$0.00	\$0.00	\$0.00	\$0.00	\$0.00	\$0.00	\$0.00	\$0.00	\$0.00	\$0.00	\$0.00	\$0.00	\$0.00	\$0.00	\$0.00	\$0.00	\$0.00	\$0.00	\$0.00	\$0.00	\$0.00	\$0.00
Hatfield, James & Patricia	9/20/2019	434	7198	\$0.00	\$0.00	\$0.00	\$0.00	\$0.00	\$0.00	\$0.00	\$0.00	\$0.00	\$0.00	\$0.00	\$0.00	\$0.00	\$0.00	\$0.00	\$0.00	\$0.00	\$0.00	\$0.00	\$0.00	\$0.00	\$0.00	\$0.00

Permit #	Permit Date	Census	Control #	Updates	Description Of Work										Total Fee
					Block & Lot	Costs	Use Group	Bldg	Elec	Fire	Plmb	Elev	Mech	AltFee	
Work Site					Eadm	Fadm	Padm	VAdm	MAdm	VolFee	CcoFee	Square Feet	DCA Min.		
Owner Name		Minimum Fees	Btotl		Etotl	Ftotl	Ptotl	Vtotl	Mtotl	TFTotl	CertTotl	Total Fee			
20190021	9/23/2019	101	7189	4 revised drawings											
8 11		\$15,500.00	R-5	\$240.00	\$0.00	\$0.00	\$0.00	\$0.00	\$0.00	\$15.00	\$0.00	\$0.00	\$0.00	0.00	
954 East Ave.		\$0.00		\$0.00	\$0.00	\$0.00	\$0.00	\$0.00	\$0.00	\$0.00	\$0.00	\$0.00	\$0.00	0.00	
LaManna Building & Land Co Inc.															
20190091	9/23/2019	434	7190	0 Deck	\$240.00	\$0.00	\$0.00	\$0.00	\$0.00	\$15.00	\$0.00	\$255.00			
13 2		\$30,000.00	R-5	\$900.00	\$0.00	\$0.00	\$0.00	\$0.00	\$0.00	\$57.00	\$0.00	\$0.00	\$0.00	0.00	
932 OCEAN AVENUE		\$0.00		\$0.00	\$0.00	\$0.00	\$0.00	\$0.00	\$0.00	\$0.00	\$0.00	\$0.00	\$0.00	0.00	
ANGOWSKI, RICHARD & JOYCE															
20190092	9/24/2019	434	7210	0 Temporary Service	\$900.00	\$0.00	\$0.00	\$0.00	\$0.00	\$57.00	\$0.00	\$957.00			
14 7.01		\$600.00	R-5	\$0.00	\$140.00	\$0.00	\$0.00	\$0.00	\$0.00	\$2.00	\$0.00	\$0.00	\$0.00	0.00	
917 BARNEGAT LANE		\$0.00		\$0.00	\$0.00	\$0.00	\$0.00	\$0.00	\$0.00	\$0.00	\$0.00	\$0.00	\$0.00	0.00	
PARKER, ROBERT & CHRISTINE															
20190093	9/25/2019	434	7191	0 Generator	\$0.00	\$140.00	\$0.00	\$0.00	\$0.00	\$2.00	\$0.00	\$142.00			
23 18		\$3,600.00	R-5	\$0.00	\$120.00	\$75.00	\$150.00	\$0.00	\$0.00	\$7.00	\$0.00	\$0.00	\$0.00	0.00	
1055 Ocean Ave.		\$0.00		\$0.00	\$0.00	\$0.00	\$0.00	\$0.00	\$0.00	\$0.00	\$0.00	\$0.00	\$0.00	0.00	
1055 Ocean Ave Mantoloking LLC															
20190094	9/27/2019	434	7228	0 Backflow preventer	\$0.00	\$120.00	\$150.00	\$0.00	\$0.00	\$7.00	\$0.00	\$352.00			
27 18		\$500.00	R-5	\$0.00	\$0.00	\$0.00	\$75.00	\$0.00	\$0.00	\$1.00	\$0.00	\$0.00	\$0.00	0.00	
1235 BAY AVENUE		\$0.00		\$0.00	\$0.00	\$0.00	\$0.00	\$0.00	\$0.00	\$0.00	\$0.00	\$0.00	\$0.00	0.00	
SCHAIBLE, RUSSELL															
20190095	9/27/2019	434	7222	0 Alterations	\$0.00	\$0.00	\$75.00	\$0.00	\$0.00	\$1.00	\$0.00	\$76.00			
27 18		\$600.00	U	\$0.00	\$75.00	\$0.00	\$0.00	\$0.00	\$0.00	\$2.00	\$0.00	\$0.00	\$0.00	0.00	
1235 BAY AVENUE		\$0.00		\$0.00	\$0.00	\$0.00	\$0.00	\$0.00	\$0.00	\$0.00	\$0.00	\$0.00	\$0.00	0.00	
SCHAIBLE, RUSSELL															
		\$3,285,268.00		\$289.00	\$25,538.00	\$250.00	\$1,830.00	\$0.00	\$0.00	\$1,928.00	\$150.00	\$30,596.00	\$0.00	\$77.00	
Grand Total															

Mantoloking Municipal Court
PO Box 247
Mantoloking, NJ 08738
1-732-475-7398

James A. Liguori
Municipal Court Judge

Elizabeth L. Boettger
Court Administrator

TO: Mayor White
Chief Ferris
B Konopada, B Clerk

Court Activity for the Month of September 2019

CRIMINAL COMPLAINTS FILED

TRAFFIC COMPLAINTS FILED

Indictable Offenses	3	Driving Under the Influence	2
Disorderly Persons	5	Traffic (Moving)	38
Special Complaints/	8	Parking	24

Tickets issued in the month of September 80

COMPARISON OF COURT RECEIPTS

	TO BOROUGH	TO ALL AGENCIES
2019 year to date receipts—TOTAL	\$18,458.02	\$36,680.50
2018 year to date receipts—TOTAL	\$39,878.43	\$71,796.94
Difference Total Receipts Payable	-\$21,420.41	-\$35,116.44

RECEIPT COMPARISON 2018

MONEY DISTRIBUTED TO THE BOROUGH OF MANTOLOKING

	JAN.	FEB	MAR	APR	MAY	JUN	JUL	AUG	SEP	OCT	NOV	DEC	TOTAL
BORO FINES & COSTS	\$6,769.50	\$2,336.46	\$1,050.00	\$3,158.00	\$1,867.73	\$4,223.38	\$5,696.26	\$7,816.39	\$5,303.13	\$3,758.50	\$3,465.38	\$640.04	\$46,084.77
CONTEMPT OF COURT	(\$85.00)	\$150.00	\$50.00	\$0.00	\$0.00	\$0.00	\$0.00	\$0.00	\$0.00	\$0.00	\$0.00	\$0.00	\$115.00
PUBLIC DEFENDER	\$0.00	\$0.00	\$0.00	\$600.00	\$0.00	\$0.00	\$40.00	\$0.00	\$160.00	\$0.00	\$15.50	\$0.00	\$815.50
GENERAL FEE	\$956.00	\$0.00	\$0.00	(\$239.00)	\$0.00	\$0.00	\$0.00	\$0.00	\$0.00	\$0.00	\$82.00	\$0.00	\$813.00
SPINAL MUNICIPAL	\$0.56	\$0.44	\$0.26	\$1.06	\$0.66	\$1.64	\$2.14	\$2.78	\$2.04	\$1.26	\$0.82	\$0.18	\$13.84
INTEREST GENERAL ACCT	\$0.31	\$0.46	\$0.20	\$0.31	\$0.48	\$0.15	\$0.00	\$0.00	\$0.00	\$0.00	\$0.00	\$0.91	\$2.82
INTEREST BAIL ACCT	\$0.00	\$0.02	\$0.14	\$0.16	\$0.13	\$0.15	\$0.15	\$0.12	\$0.01	\$0.00	\$0.00	\$0.00	\$0.88
STATE INSPECTION REBATE 6-1	\$0.00	\$0.00	\$0.00	\$0.00	\$0.00	\$0.00	\$0.00	\$0.00	\$0.00	\$0.00	\$0.00	\$0.00	\$0.00
POAA***-FTA	\$4.00	\$0.00	\$2.00	\$2.00	\$0.00	\$0.00	\$6.00	\$18.00	\$20.00	\$10.00	\$16.00	\$4.00	\$82.00
OVERPAYMENTS**	\$9.00	(\$11.00)	\$0.00	\$0.00	\$0.00	\$0.00	\$19.00	\$12.00	(\$17.00)	(\$14.00)	\$0.00	\$0.00	(\$2.00)

***POAA IS A FUND AND IS NOT INCLUDED IN THE TOTAL PAID TO BOROUGH AMT *** OP'S ARE LISTED FOR AUDITING PURPOSES ONLY - NOT IN TOTAL

TOTAL PAID 2018	\$7,641.06	\$2,486.90	\$1,100.26	\$3,520.06	\$1,868.39	\$4,225.02	\$5,738.40	\$7,833.17	\$5,465.17	\$3,759.76	\$3,563.70	\$640.22	\$47,842.11
TOTAL PAID 2017	\$2,024.80	\$3,113.57	\$1,605.20	\$3,698.28	\$1,886.27	\$5,588.62	\$2,784.46	\$3,784.66	\$3,863.58	\$2,005.08	\$2,174.02	\$1,257.94	\$33,786.48
TOTAL PAID 2016	\$1,769.30	\$1,632.82	\$3,317.28	\$2,027.45	\$795.72	\$2,648.97	\$6,520.87	\$9,041.48	\$7,639.88	\$3,700.05	\$2,794.58	\$2,237.68	\$44,126.08
TOTAL PAID 2015	\$1,496.84	\$1,578.43	\$1,539.24	\$1,291.22	\$2,303.18	\$4,052.52	\$4,581.20	\$6,495.56	\$7,184.82	\$2,574.62	\$2,676.14	\$2,837.88	\$38,611.65
TOTAL PAID 2014	\$2,943.43	\$4,538.88	\$2,806.72	\$3,562.47	\$1,838.18	\$6,874.24	\$5,233.48	\$6,670.86	\$3,515.64	\$4,399.74	\$1,767.43	\$1,324.82	\$45,475.89
TOTAL PAID 2013	\$3,047.94	\$4,681.52	\$6,098.70	\$4,397.48	\$4,634.16	\$2,954.23	\$6,204.70	\$8,590.31	\$5,158.95	\$3,763.00	\$4,583.33	\$4,022.42	\$58,136.74
TOTAL PAID 2012	\$3,376.26	\$3,040.37	\$5,245.15	\$3,152.38	\$4,063.39	\$4,834.77	\$5,842.37	\$8,154.11	\$7,889.15	\$5,691.92	\$2,286.25	\$1,821.05	\$55,397.17
TOTAL PAID 2011	\$3,215.69	\$3,822.29	\$6,196.02	\$3,052.73	\$4,700.11	\$6,355.73	\$9,415.30	\$8,965.12	\$5,220.30	\$4,397.67	\$2,809.42	\$2,781.97	\$60,932.35
TOTAL PAID 2010	\$5,142.25	\$5,160.17	\$4,340.50	\$4,098.09	\$4,783.16	\$4,013.34	\$6,419.24	\$9,455.31	\$7,404.02	\$6,183.66	\$4,145.36	\$3,601.82	\$64,746.92
TOTAL PAID 2009	\$4,962.43	\$6,954.24	\$4,737.06	\$3,341.90	\$5,716.81	\$7,701.70	\$10,725.24	\$9,631.36	\$9,586.15	\$6,542.74	\$2,977.25	\$3,411.90	\$76,288.76
TOTAL PAID 2008	\$8,973.87	\$5,200.85	\$4,993.47	\$4,321.86	\$8,525.49	\$6,245.79	\$15,051.82	\$10,822.69	\$8,531.37	\$7,922.76	\$4,684.86	\$4,082.82	\$89,337.65
TOTAL PAID 2007	\$7,227.88	\$4,154.42	\$8,348.85	\$5,283.44	\$7,267.55	\$11,485.88	\$8,080.23	\$10,841.73	\$8,632.30	\$8,676.13	\$6,382.00	\$4,915.91	\$91,296.32
TOTAL PAID 2006	\$8,288.89	\$7,001.25	\$5,039.01	\$5,860.42	\$5,308.56	\$5,760.39	\$8,474.38	\$12,535.01	\$7,430.51	\$7,889.29	\$6,845.13	\$5,963.41	\$86,296.25
TOTAL PAID 2005	\$1,563.34	\$4,476.03	\$2,875.83	\$5,620.60	\$5,843.06	\$5,949.82	\$5,064.38	\$10,971.10	\$10,485.97	\$11,554.70	\$7,119.27	\$10,836.36	\$82,360.46
2018/2017 DIFF	\$5,616.26	(\$626.67)	(\$504.94)	(\$178.22)	(\$17.88)	(\$1,363.60)	\$2,953.94	\$4,048.51	\$1,601.59	\$1,754.68	\$1,389.68	(\$617.72)	\$14,055.63
MONEY DISBURSED TO THE COUNTY													
COUNTY SPLIT	\$870.50	\$1,285.00	\$709.50	\$1,431.00	\$1,153.50	\$1,881.00	\$2,690.00	\$3,825.50	\$2,196.50	\$2,260.00	\$1,236.50	\$172.00	\$19,711.00

MONEY DISBURSED TO THE STATE												
TRAFFIC SIGN	\$50.00	\$0.00	\$50.00	\$0.00	\$50.00	\$100.00	\$0.00	\$0.00	\$0.00	\$0.00	\$0.00	\$300.00
FINES	\$0.00	\$0.00	\$0.00	\$322.00	\$0.00	\$100.00	\$0.00	\$100.00	\$0.00	\$100.00	\$0.00	\$742.00
INSPECTION VIOLATIONS	\$0.00	\$100.00	\$0.00	\$0.00	\$300.00	\$200.00	\$0.00	\$0.00	\$0.00	\$0.00	\$0.00	\$894.00
EMTFF	\$14.50	\$12.00	\$6.50	\$26.00	\$15.50	\$72.00	\$55.50	\$33.50	\$20.00	\$33.50	\$4.00	\$352.00
BODY ARMOR	\$28.00	\$21.00	\$13.00	\$52.00	\$33.00	\$82.00	\$107.00	\$139.00	\$102.00	\$63.00	\$9.00	\$689.00
DNA TESTING 12/21/03	\$56.00	\$44.00	\$26.00	\$106.00	\$66.00	\$164.00	\$214.00	\$278.00	\$204.00	\$126.00	\$18.00	\$1,382.00
MARINE POLICE	\$0.00	\$0.00	\$0.00	\$0.00	\$0.00	\$0.00	\$0.00	\$0.00	\$0.00	\$0.00	\$0.00	\$0.00
CELL PHONE	\$0.00	\$0.00	\$0.00	\$100.00	\$0.00	\$100.00	\$0.00	\$0.00	\$0.00	\$0.00	\$0.00	\$700.00
SPINAL RESEARCH	\$27.44	\$21.56	\$12.74	\$51.94	\$32.34	\$136.22	\$99.96	\$61.74	\$40.18	\$8.82	\$678.16	\$678.16
DRUG EDUCATION	\$0.00	\$0.00	\$30.00	\$20.00	\$0.00	\$0.00	\$0.00	\$0.00	\$50.00	\$0.00	\$0.00	\$100.00
DOM. VIOLENCE SC	\$0.00	\$0.00	\$0.00	\$0.00	\$0.00	\$0.00	\$0.00	\$0.00	\$0.00	\$0.00	\$0.00	\$0.00
FOAA-SUSPENSION	\$0.00	\$3.00	\$0.00	\$3.00	\$0.00	\$0.00	\$0.00	\$0.00	\$6.00	\$0.00	\$0.00	\$15.00
UNINSURED MOTORIST	\$125.00	\$84.00	\$25.00	\$91.00	\$75.00	\$125.00	\$25.00	\$150.00	\$75.00	\$150.00	\$0.00	\$1,025.00
AUTISM 2/20/04	\$28.00	\$21.00	\$13.00	\$52.00	\$33.00	\$82.00	\$107.00	\$139.00	\$102.00	\$63.00	\$9.00	\$689.00
BRAIN INJURY 6/30/04	\$28.00	\$21.00	\$13.00	\$52.00	\$33.00	\$82.00	\$107.00	\$139.00	\$102.00	\$63.00	\$9.00	\$689.00
UNSAFE DRIVING 7/1/2004	\$270.00	\$45.00	\$20.00	\$70.00	\$84.00	\$0.00	\$0.00	\$0.00	\$250.00	\$500.00	\$0.00	\$1,239.00
DWI-GENERAL FUND	\$12.50	\$50.00	\$0.00	\$50.00	\$6.25	\$22.24	\$59.86	\$70.12	\$12.50	\$32.37	\$2.62	\$319.83
DWI ENFORCEMENT	\$25.00	\$100.00	\$0.00	\$100.00	\$12.50	\$2.75	\$44.50	\$119.75	\$140.25	\$25.00	\$5.25	\$639.75
TOTAL PAID TO STATE	\$664.44	\$522.56	\$209.24	\$1,095.94	\$540.59	\$1,562.98	\$1,151.10	\$1,122.33	\$947.74	\$988.30	\$65.69	\$10,453.74
MONEY DISBURSED TO MISC. AGENCIES												
ATS	\$180.00	\$125.00	\$65.00	\$265.00	\$155.00	\$425.00	\$580.00	\$780.00	\$530.00	\$335.00	\$210.00	\$3,695.00
VCCB	\$0.00	\$50.00	\$0.00	\$50.00	\$0.00	\$0.00	\$150.00	\$50.00	\$50.00	\$50.00	\$0.00	\$450.00
DEDR	(\$200.00)	\$188.00	\$0.00	\$40.00	\$0.00	\$80.00	\$80.00	\$60.00	\$0.00	\$0.00	\$500.00	\$748.00
COUNTY LAB	\$0.00	\$10.00	\$40.00	\$0.00	\$0.00	\$0.00	\$0.00	\$0.00	\$0.00	\$0.00	\$0.00	\$100.00
SN	(\$65.00)	\$140.00	\$0.00	\$75.00	\$0.00	\$0.00	\$214.50	\$85.50	\$0.00	\$44.50	\$105.50	\$600.00
WEB FEES - INTERNET PAYMENTS	\$46.00	\$34.00	\$37.00	\$76.00	\$56.00	\$112.00	\$146.00	\$188.00	\$174.00	\$104.00	\$21.00	\$1,064.00
PED SAFETY	\$0.00	\$0.00	\$0.00	\$0.00	\$0.00	\$0.00	\$0.00	\$0.00	\$0.00	\$0.00	\$0.00	\$0.00
CONDITIONAL DISCHARGE	\$0.00	\$0.00	\$0.00	\$0.00	\$0.00	\$0.00	\$0.00	\$0.00	\$0.00	\$0.00	\$0.00	\$75.00
RESTITUTION	\$0.00	\$0.00	\$0.00	\$0.00	\$0.00	\$0.00	\$0.00	\$0.00	\$0.00	\$0.00	\$0.00	\$0.00
STATE LAB	\$0.00	\$0.00	\$0.00	\$0.00	\$0.00	\$0.00	\$0.00	\$0.00	\$0.00	\$0.00	\$0.00	\$0.00
SFCA TO BORO	\$0.00	\$0.00	\$0.00	\$0.00	\$0.00	\$0.00	\$0.00	\$0.00	\$0.00	\$0.00	\$0.00	\$0.00
FISH & GAME	\$0.00	\$0.00	\$0.00	\$0.00	\$0.00	\$0.00	\$500.00	\$1,700.00	\$100.00	\$0.00	\$60.00	\$2,360.00
TOTAL PAID TO MISC AG.	(\$39.00)	\$547.00	\$142.00	\$506.00	\$211.00	\$617.00	\$1,670.50	\$2,863.50	\$854.00	\$533.50	\$1,120.50	\$9,092.00
TOTAL REC 2018	\$9,141.00	\$4,841.46	\$2,163.00	\$6,555.00	\$3,773.48	\$8,286.00	\$11,256.00	\$16,123.00	\$9,658.00	\$7,511.00	\$6,925.00	\$87,180.85
TOTAL RECEIPTS 2017	\$3,767.00	\$6,666.00	\$2,809.00	\$7,399.00	\$4,281.00	\$7,216.00	\$5,038.00	\$7,214.00	\$6,946.00	\$4,093.00	\$3,862.00	\$61,681.00
TOTAL RECEIPTS 2016	\$4,006.00	\$3,190.00	\$6,292.00	\$4,694.10	\$1,533.00	\$4,702.00	\$11,381.00	\$14,670.00	\$11,950.00	\$5,297.00	\$5,670.00	\$78,684.10
TOTAL RECEIPTS 2015	\$3,730.00	\$3,155.00	\$3,516.00	\$3,182.00	\$5,363.90	\$8,420.17	\$8,194.00	\$11,485.00	\$14,284.00	\$5,524.22	\$5,412.00	\$77,730.29
TOTAL RECEIPTS 2014	\$7,556.00	\$8,661.00	\$6,202.00	\$8,044.00	\$3,794.00	\$12,779.00	\$9,341.00	\$12,057.00	\$6,769.00	\$7,985.00	\$3,305.00	\$90,043.00
TOTAL RECEIPTS 2013	\$5,450.00	\$8,257.00	\$10,896.00	\$8,807.00	\$6,323.50	\$6,304.00	\$12,630.00	\$16,019.00	\$9,214.00	\$6,572.00	\$10,175.00	\$111,152.50
TOTAL RECEIPTS 2012	\$6,607.99	\$5,989.28	\$8,841.68	\$6,490.07	\$6,915.64	\$10,267.16	\$11,533.50	\$14,224.24	\$15,093.15	\$9,880.60	\$4,601.05	\$104,115.10
TOTAL RECEIPTS 2011	\$6,128.00	\$6,592.26	\$11,264.30	\$6,096.55	\$8,737.27	\$11,074.07	\$16,619.42	\$16,260.74	\$9,687.64	\$8,877.42	\$5,783.74	\$112,559.51
DIF/ALL 2018-2017	\$5,374.00	(\$1,824.54)	(\$646.00)	(\$844.00)	(\$507.52)	\$1,070.00	\$6,218.00	\$8,909.00	\$2,712.00	\$3,418.00	\$0.00	\$26,941.94

RECEIPT COMPARISON 2019

MONEY DISTRIBUTED TO THE BOROUGH OF MANTOLOKING

	JAN.	FEB	MAR	APR	MAY	JUN	JUL	AUG	SEP	OCT	NOV	DEC	TOTAL
BORO FINES & COSTS	\$2,071.00	\$846.63	\$1,186.00	\$1,940.38	\$1,540.63	\$1,629.50	\$3,614.00	\$3,516.50	\$1,274.00	\$0.00	\$0.00	\$0.00	\$17,618.64
CONTEMPT OF COURT	\$0.00	\$0.00	\$0.00	\$0.00	\$0.00	\$0.00	\$0.00	\$0.00	\$0.00	\$0.00	\$0.00	\$0.00	\$0.00
PUBLIC DEFENDER	\$250.00	\$244.00	\$0.00	\$171.50	\$69.50	\$25.00	\$50.00	\$50.00	\$50.00	\$0.00	\$0.00	\$0.00	\$910.00
GENERAL FEE	\$0.00	\$0.00	(\$82.00)	\$0.00	\$0.00	\$0.00	\$0.00	\$0.00	\$5.00	\$0.00	\$0.00	\$0.00	(\$77.00)
SPINAL MUNICIPAL	\$0.44	\$0.22	\$0.20	\$0.48	\$0.58	\$0.86	\$1.40	\$1.46	\$0.74	\$0.00	\$0.00	\$0.00	\$6.38
INTEREST GENERAL ACCT	\$0.56	\$0.81	\$0.75	\$1.03	\$0.91	\$0.81	\$1.36	\$1.51	\$0.00	\$0.00	\$0.00	\$0.00	\$7.74
INTEREST BAIL ACCT	\$0.13	\$0.10	\$0.14	\$0.16	\$0.00	\$0.00	\$0.00	\$0.00	\$0.00	\$0.00	\$0.00	\$0.00	\$0.53
INSPECTION REBATE 6-1	\$0.00	\$0.00	\$0.00	\$0.00	\$0.00	\$0.00	\$0.00	\$0.00	\$0.00	\$0.00	\$0.00	\$0.00	\$0.00
POAA***FTA	\$4.00	\$2.00	\$2.00	\$0.00	\$0.00	\$0.00	\$4.00	\$14.00	\$0.00	\$0.00	\$0.00	\$0.00	\$26.00
OVERPAYMENTS***	\$0.00	\$0.00	\$0.00	\$0.00	\$0.00	\$0.00	\$0.00	\$1.00	(\$1.00)	\$0.00	\$0.00	\$0.00	\$0.00
***POAA IS A FUND AND IS NOT INCLUDED IN THE TOTAL PAID TO BOROUGH AMT *** OP'S ARE LISTED FOR AUDITING PURPOSES ONLY - NOT IN TOTAL													
TOTAL PAID 2019	\$2,321.44	\$1,090.85	\$1,104.20	\$2,112.36	\$1,610.71	\$1,655.36	\$3,665.40	\$3,567.96	\$1,329.74	\$0.00	\$0.00	\$0.00	\$18,458.02

TOTAL PAID 2018	\$7,641.06	\$2,486.90	\$1,100.26	\$3,520.06	\$1,868.39	\$4,225.02	\$5,738.40	\$7,833.17	\$5,465.17	\$3,759.76	\$3,563.70	\$640.22	\$47,842.11
TOTAL PAID 2017	\$2,024.80	\$3,113.57	\$1,605.20	\$3,698.28	\$1,886.27	\$5,588.62	\$2,784.46	\$3,784.66	\$3,863.58	\$2,005.08	\$2,174.02	\$1,257.94	\$33,786.48
TOTAL PAID 2016	\$1,769.30	\$1,632.82	\$3,317.28	\$2,027.45	\$795.72	\$2,648.97	\$6,520.87	\$9,041.48	\$7,639.88	\$3,700.05	\$2,794.58	\$2,237.68	\$44,126.08
TOTAL PAID 2015	\$1,496.84	\$1,578.43	\$1,539.24	\$1,291.22	\$2,303.18	\$4,052.52	\$4,581.20	\$6,495.56	\$7,184.82	\$2,574.62	\$2,676.14	\$2,837.88	\$38,611.65
TOTAL PAID 2014	\$2,943.43	\$4,538.88	\$2,806.72	\$3,562.47	\$1,838.18	\$6,874.24	\$5,233.48	\$6,670.86	\$3,515.64	\$4,399.74	\$1,767.43	\$1,324.82	\$45,475.89
TOTAL PAID 2013	\$3,047.94	\$4,681.52	\$6,098.70	\$4,397.48	\$4,634.16	\$2,954.23	\$6,204.70	\$8,590.31	\$5,158.95	\$3,763.00	\$4,583.33	\$4,022.42	\$58,136.74
TOTAL PAID 2012	\$3,376.26	\$3,040.37	\$5,245.15	\$3,152.38	\$4,063.39	\$4,834.77	\$5,842.37	\$8,154.11	\$7,889.15	\$5,691.92	\$2,286.25	\$1,821.05	\$55,397.17
TOTAL PAID 2011	\$3,215.69	\$3,822.29	\$6,196.02	\$3,052.73	\$4,700.11	\$6,355.73	\$9,415.30	\$8,965.12	\$5,220.30	\$4,397.67	\$2,809.42	\$2,781.97	\$60,932.35
TOTAL PAID 2010	\$5,142.25	\$5,160.17	\$4,340.50	\$4,098.09	\$4,783.16	\$4,013.34	\$6,419.24	\$9,455.31	\$7,404.02	\$6,183.66	\$4,145.36	\$3,601.82	\$64,746.92
TOTAL PAID 2009	\$4,962.43	\$6,954.24	\$4,737.06	\$3,341.90	\$5,716.81	\$7,701.70	\$10,725.24	\$9,631.36	\$9,586.15	\$6,542.74	\$2,977.25	\$3,411.90	\$76,288.78
TOTAL PAID 2008	\$8,973.87	\$5,200.85	\$4,993.47	\$4,321.86	\$8,525.49	\$6,245.79	\$15,051.82	\$10,822.69	\$8,531.37	\$7,922.76	\$4,664.86	\$4,082.82	\$89,337.65
TOTAL PAID 2007	\$7,227.88	\$4,154.42	\$8,348.85	\$5,283.44	\$7,267.55	\$11,485.88	\$8,080.23	\$10,841.73	\$8,632.30	\$8,676.13	\$6,382.00	\$4,915.91	\$91,296.32
TOTAL PAID 2006	\$8,288.89	\$7,001.25	\$5,039.01	\$5,860.42	\$5,308.56	\$5,760.39	\$8,474.38	\$12,535.01	\$7,430.51	\$7,889.29	\$6,845.13	\$5,863.41	\$86,296.25
TOTAL PAID 2005	\$1,563.34	\$4,476.03	\$2,875.83	\$5,620.60	\$5,843.06	\$5,949.82	\$5,064.38	\$10,971.10	\$10,485.97	\$11,554.70	\$7,119.27	\$10,836.36	\$82,360.46
2019/2018 DIFF	(\$5,319.62)	(\$1,396.05)	\$3.94	(\$1,407.70)	(\$257.65)	(\$2,569.66)	(\$2,073.00)	(\$4,265.21)	(\$4,135.43)	(\$3,759.76)	(\$3,563.70)	(\$640.22)	(\$29,384.09)

MONEY DISBURSED TO THE COUNTY													
COUNTY SPLT	\$1,395.00	\$516.00	\$539.50	\$1,244.00	\$853.50	\$759.00	\$1,576.50	\$1,632.50	\$480.50	\$0.00	\$0.00	\$0.00	\$8,996.50

MONEY DISBURSED TO THE STATE													
TRAFFIC SIGN	\$0.00	\$0.00	\$0.00	\$0.00	\$0.00	\$50.00	\$0.00	\$100.00	\$0.00	\$0.00	\$0.00	\$0.00	\$150.00
FINES	\$0.00	\$78.00	\$0.00	\$0.00	\$0.00	\$0.00	\$0.00	\$0.00	\$0.00	\$0.00	\$0.00	\$0.00	\$78.00
INSPECTION	\$0.00	\$0.00	\$0.00	\$100.00	\$0.00	\$0.00	\$0.00	\$0.00	\$0.00	\$0.00	\$0.00	\$0.00	\$100.00
EMITF	\$11.00	\$6.00	\$5.00	\$13.50	\$14.50	\$21.50	\$36.50	\$37.50	\$18.50	\$0.00	\$0.00	\$0.00	\$164.00
BODY ARMOR	\$22.00	\$11.00	\$9.00	\$24.00	\$29.00	\$43.00	\$70.00	\$73.00	\$37.00	\$0.00	\$0.00	\$0.00	\$318.00

DNA TESTING 12/21/03	\$44.00	\$22.00	\$20.00	\$48.00	\$58.00	\$86.00	\$140.00	\$146.00	\$74.00	\$0.00	\$0.00	\$0.00	\$638.00
MARINE POLICE	\$0.00	\$0.00	\$0.00	\$0.00	\$0.00	\$0.00	\$0.00	\$0.00	\$0.00	\$0.00	\$0.00	\$0.00	\$0.00
CELL PHONE	\$0.00	\$0.00	\$0.00	\$0.00	\$0.00	\$0.00	\$0.00	\$0.00	\$0.00	\$0.00	\$0.00	\$0.00	\$0.00
SPINAL RESEARCH	\$21.56	\$10.78	\$9.80	\$23.52	\$28.42	\$42.14	\$68.60	\$71.54	\$36.26	\$0.00	\$0.00	\$0.00	\$312.62
DRUG EDUCATION	\$0.00	\$0.00	\$100.00	\$0.00	\$0.00	\$0.00	\$50.00	\$0.00	\$0.00	\$0.00	\$0.00	\$0.00	\$150.00
DOM. VIOLENCE SC	\$0.00	\$0.00	\$0.00	\$0.00	\$0.00	\$0.00	\$0.00	\$0.00	\$0.00	\$0.00	\$0.00	\$0.00	\$0.00
POAA-SUSPENSION	\$0.00	\$0.00	\$3.00	\$0.00	\$0.00	\$0.00	\$0.00	\$0.00	\$0.00	\$0.00	\$0.00	\$0.00	\$3.00
UNINSURED MOTORIST	\$0.00	\$0.00	\$0.00	\$0.00	\$25.00	\$25.00	\$75.00	\$100.00	\$0.00	\$0.00	\$0.00	\$0.00	\$225.00
AUTISM 2/2004	\$22.00	\$11.00	\$9.00	\$24.00	\$29.00	\$43.00	\$70.00	\$73.00	\$37.00	\$0.00	\$0.00	\$0.00	\$318.00
BRAIN INJURY 6/30/04	\$22.00	\$11.00	\$9.00	\$24.00	\$29.00	\$43.00	\$70.00	\$73.00	\$37.00	\$0.00	\$0.00	\$0.00	\$318.00
UNSAFE DRIVING 7/1/2004	\$0.00	\$0.00	\$0.00	\$250.00	\$0.00	\$0.00	\$500.00	\$44.50	\$50.00	\$0.00	\$0.00	\$0.00	\$844.50
DWI-GENERAL FUND	\$75.00	\$5.12	\$12.50	\$144.87	\$7.62	\$0.00	\$0.00	\$0.00	\$0.00	\$0.00	\$0.00	\$0.00	\$245.11
DWI ENFORCEMENT	\$150.00	\$10.25	\$25.00	\$289.75	\$15.25	\$0.00	\$0.00	\$0.00	\$0.00	\$0.00	\$0.00	\$0.00	\$490.25
TOTAL TO STATE	\$367.56	\$165.15	\$202.30	\$941.64	\$235.79	\$353.64	\$1,080.10	\$718.54	\$289.76	\$0.00	\$0.00	\$0.00	\$4,354.48

MONEY DISBURSED TO MISC. AGENCIES

ATS	\$115.00	\$60.00	\$45.00	\$135.00	\$145.00	\$215.00	\$385.00	\$400.00	\$185.00	\$0.00	\$0.00	\$0.00	\$1,685.00
VCCB	\$50.00	\$0.00	\$0.00	\$150.00	\$0.00	\$0.00	\$100.00	\$0.00	\$0.00	\$0.00	\$0.00	\$0.00	\$300.00
DEDR	\$0.00	\$0.00	\$1,160.00	\$0.00	\$0.00	\$60.00	\$20.00	\$100.00	\$120.00	\$0.00	\$0.00	\$0.00	\$1,460.00
COUNTY LAB	\$20.00	\$0.00	\$63.00	\$0.00	\$0.00	\$0.00	\$50.00	\$0.00	\$0.00	\$0.00	\$0.00	\$0.00	\$133.00
SN	\$150.00	\$0.00	\$0.00	\$225.00	\$0.00	\$0.00	\$114.00	\$0.00	\$0.00	\$0.00	\$0.00	\$0.00	\$469.00
WEB FEES	\$39.00	\$33.00	\$0.00	\$52.00	\$51.00	\$64.06	\$114.81	\$76.11	\$38.52	\$0.00	\$0.00	\$0.00	\$468.50
PED SAFETY	\$0.00	\$0.00	\$0.00	\$0.00	\$0.00	\$0.00	\$0.00	\$0.00	\$0.00	\$0.00	\$0.00	\$0.00	\$0.00
CD	\$0.00	\$0.00	\$0.00	\$0.00	\$0.00	\$0.00	\$0.00	\$0.00	\$0.00	\$0.00	\$0.00	\$0.00	\$0.00
RESTITUTION	\$0.00	\$0.00	\$0.00	\$0.00	\$0.00	\$0.00	\$0.00	\$0.00	\$0.00	\$0.00	\$0.00	\$0.00	\$0.00
STATE LAB	\$0.00	\$0.00	\$0.00	\$0.00	\$0.00	\$0.00	\$0.00	\$0.00	\$0.00	\$0.00	\$0.00	\$0.00	\$0.00
SPCA TO BORO	\$0.00	\$0.00	\$0.00	\$0.00	\$0.00	\$0.00	\$0.00	\$0.00	\$0.00	\$0.00	\$0.00	\$0.00	\$0.00
FISH & GAME	\$0.00	\$0.00	\$0.00	\$0.00	\$0.00	\$0.00	\$0.00	\$310.00	\$0.00	\$0.00	\$0.00	\$0.00	\$310.00
TOTAL TO MISC AG.	\$374.00	\$93.00	\$1,268.00	\$562.00	\$196.00	\$339.06	\$783.81	\$886.11	\$343.52	\$0.00	\$0.00	\$0.00	\$4,845.50

TOTAL REC 2019	\$4,462.00	\$1,867.00	\$3,116.00	\$4,860.00	\$2,896.00	\$3,107.06	\$7,109.81	\$6,819.11	\$2,443.52	\$0.00	\$0.00	\$0.00	\$36,680.50
TOTAL RECEIPTS 2018	\$9,141.00	\$4,841.46	\$2,163.00	\$6,555.00	\$3,773.48	\$8,286.00	\$11,256.00	\$16,123.00	\$9,658.00	\$7,511.00	\$6,925.00	\$947.91	\$87,180.85
TOTAL RECEIPTS 2017	\$3,767.00	\$6,666.00	\$2,809.00	\$7,399.00	\$4,281.00	\$7,216.00	\$5,038.00	\$7,214.00	\$6,946.00	\$4,093.00	\$3,862.00	\$2,390.00	\$61,681.00
TOTAL RECEIPTS 2016	\$4,006.00	\$3,190.00	\$6,292.00	\$4,694.10	\$1,533.00	\$4,702.00	\$11,381.00	\$14,670.00	\$11,950.00	\$5,297.00	\$5,670.00	\$5,299.00	\$78,684.10
TOTAL RECEIPTS 2015	\$3,730.00	\$3,155.00	\$3,516.00	\$3,182.00	\$5,363.90	\$8,420.17	\$8,194.00	\$11,485.00	\$14,284.00	\$5,524.22	\$5,412.00	\$5,464.00	\$77,730.29
TOTAL RECEIPTS 2014	\$7,556.00	\$8,661.00	\$6,202.00	\$8,044.00	\$3,794.00	\$12,779.00	\$9,341.00	\$12,057.00	\$6,769.00	\$7,985.00	\$3,305.00	\$3,550.00	\$90,043.00
TOTAL RECEIPTS 2013	\$5,450.00	\$8,257.00	\$10,896.00	\$8,807.00	\$8,323.50	\$6,304.00	\$12,630.00	\$16,019.00	\$9,214.00	\$6,572.00	\$10,175.00	\$8,505.00	\$111,152.50
TOTAL RECEIPTS 2012	\$6,607.99	\$5,989.28	\$6,841.68	\$6,490.07	\$6,915.64	\$10,267.16	\$11,533.50	\$14,224.24	\$15,093.15	\$9,880.60	\$4,601.05	\$3,670.74	\$104,115.10
TOTAL RECEIPTS 2011	\$6,128.00	\$6,592.26	\$11,264.30	\$6,096.55	\$8,737.27	\$11,074.07	\$16,619.42	\$16,260.74	\$9,687.64	\$8,877.42	\$5,783.74	\$5,438.10	\$112,559.51
DIF/ALL 2019-2018	(\$4,679.00)	(\$2,974.46)	\$953.00	(\$1,695.00)	(\$877.48)	(\$5,178.94)	(\$4,146.19)	(\$9,303.89)	(\$7,214.48)	(\$7,511.00)	(\$6,925.00)	(\$947.91)	(\$50,500.35)

**2019 ACTIVITY REPORT - MANTOLOKING
COMPLAINTS FILED COMPARISON
CRIMINAL OFFENSES TRAFFIC OFFENSES**

	INDICTABLE OFFENSES	DISORDERLY PERSONS	BOROUGH ORDINANCES	DWI TICKETS	TRAFFIC TICKETS	PARKING TICKETS	MONTHLY TOTALS
January	0	0	0	1	21	3	25
February	0	0	0	0	7	1	8
March	0	0	0	0	13	3	16
April	0	0	0	1	15	12	28
May	0	0	1	1	32	27	61
June	0	0	2	2	53	33	90
July	2	0	2	1	37	41	83
August	2	8	5	6	73	39	133
September	3	5	8	2	38	24	80
October	0	0	0	0	0	0	0
November	0	0	0	0	0	0	0
December	0	0	0	0	0	0	0

TOTAL 2019	7	13	18	14	289	183	524
-------------------	----------	-----------	-----------	-----------	------------	------------	------------

TOTAL 2018	7	10	46	11	538	259	871
TOTAL 2017	4	12	52	5	316	142	531
TOTAL 2016	11	10	35	11	332	540	939
TOTAL 2015	1	11	30	19	460	310	831
TOTAL 2014	10	20	22	11	394	241	698
TOTAL 2013	2	56	75	21	743	486	1383
TOTAL 2012	24	31	44	14	574	287	974
TOTAL 2011	31	27	55	20	706	180	1019
TOTAL 2010	6	11	79	21	636	210	963
TOTAL 2009	6	25	147	22	643	228	1071
TOTAL 2008	11	24	65	19	923	277	1319
TOTAL 2007	72	24	64	39	901	241	1341
TOTAL 2006	4	23	53	46	783	326	1235
TOTAL 2005	6	18	43	53	1002	279	1401
TOTAL 2004	4	11	36	32	696	228	1007
TOTAL 2003	2	21	48	17	588	198	874
TOTAL 2002	9	13	48	13	478	182	743
TOTAL 2001	1	10	25	13	569	269	887
TOTAL 2000	2	16	37	22	700	249	1026
TOTAL 1999	4	13	64	42	1119	356	1598
TOTAL 1998	7	9	130	29	811	475	1461

Table 1 - Mantoloking Borough Public Access Locations Preserved under Deed of Dedication and Perpetual Public Access Easement with the NJDEP

Municipal Public Access Plan (MPAP) Map ID Number	General Location	Description
A-1	East Ave/Carrigan Pl	10 foot wide Right-of-Way from East Avenue to beach
A-2	East Ave/Williams Pl	10 foot wide Right-of-Way from East Avenue to beach
A-3	East Ave/Newman Pl	10 foot wide Right-of-Way from East Avenue to beach
A-4	East Ave/Stephans Pl	10 foot wide Right-of-Way from East Avenue to beach
A-5	Lyman St (Ocean)	50 foot wide Right-of-Way from East Avenue to beach
A-6	NJ 35 (Between BLK 23 Lots 10, 11)	10 foot wide Right-of-Way from NJDOT Route 35 to beach
A-7	NJ 35 (Between BLK 23 Lots 26, 27)	10 foot wide Right-of-Way from NJDOT Route 35 to beach
A-8	NJ 35 (Between BLK 23 Lots 33, 34)	10 foot wide Right-of-Way from NJDOT Route 35 to beach
A-9	NJ 35 (Between BLK 23 Lots 43, 44)	10 foot wide Right-of-Way from NJDOT Route 35 to beach
A-10	NJ 35/Rt 528 (Herbert St)	10 foot wide easement from NJDOT Route 35 to beach
A-11	Downer Ave (Ocean)	50 foot wide Right-of-Way from NJDOT Route 35 to beach
A-12	Princeton Ave (Ocean)	40 foot wide Right-of-Way from NJDOT Route 35 to beach
A-13	NJ 35/Albertson St (Ocean)	40 foot wide Right-of-Way from NJDOT Route 35 to beach
A-14	NJ 35 South; Between BLK 41 Lots 11, 12 (Ocean)	6 foot wide easement from NJDOT Route 35 to beach
A-15	Albertson St (Bay)	40 foot wide Right-of-Way from Runyon Avenue to Barnegat Bay
A-16	Princeton Ave (Bay)	40 foot wide Right-of-Way from Bay Avenue to Barnegat Bay
A-17	Arnold St	50 foot wide Right-of-Way from Bay Avenue to Barnegat Bay
A-18	Downer Ave (Bay)	50 foot wide Right-of-Way from Bay Avenue to Barnegat Bay
A-19	Old Bridge St	50 foot wide Right-of-Way from Bay Avenue to Barnegat Bay
A-20	Barnegat Ln (Between BLK 22 Lots 43, 44)	10 foot wide Right-of-Way from Barnegat Lane to Barnegat Bay
A-21	Barnegat Ln (Between BLK 22 Lots 33, 34)	10 foot wide Right-of-Way from Barnegat Lane to Barnegat Bay
A-22	Barnegat Ln (Between BLK 22 Lots 23, 25)	10 foot wide Right-of-Way from Barnegat Lane to Barnegat Bay
A-23	Barnegat Ln (Between BLK 22 Lots 10, 11)	10 foot wide Right-of-Way from Barnegat Lane to Barnegat Bay
A-24	Lyman St (Bay)	50 foot wide Right-of-Way from Barnegat Lane to Barnegat Bay
A-25	Bergen Ave	Bergen Avenue Right of Way adjacent to lagoons between Block 16, Lot 12 and Block 15, Lot 14 on the North side of Bergen Ave and between Block 20, Lot 1 and Block 21, Lot 1 on the South side of Bergen Avenue to Barnegat Bay/Lagoons Waterline
A-26	Lagoon Ln (South)	Lagoon Lane Right of Way area between Block 19, Lot 25 and Block 20, Lot 16 and extension to Barnegat Bay South Lagoon Shoreline
A-27	Lagoon Ln (North)	Lagoon Lane Right of Way area between Block 17, Lot 1 and Block 16, Lot 1 and extension to Barnegat Bay North Lagoon Bulkhead/Shoreline

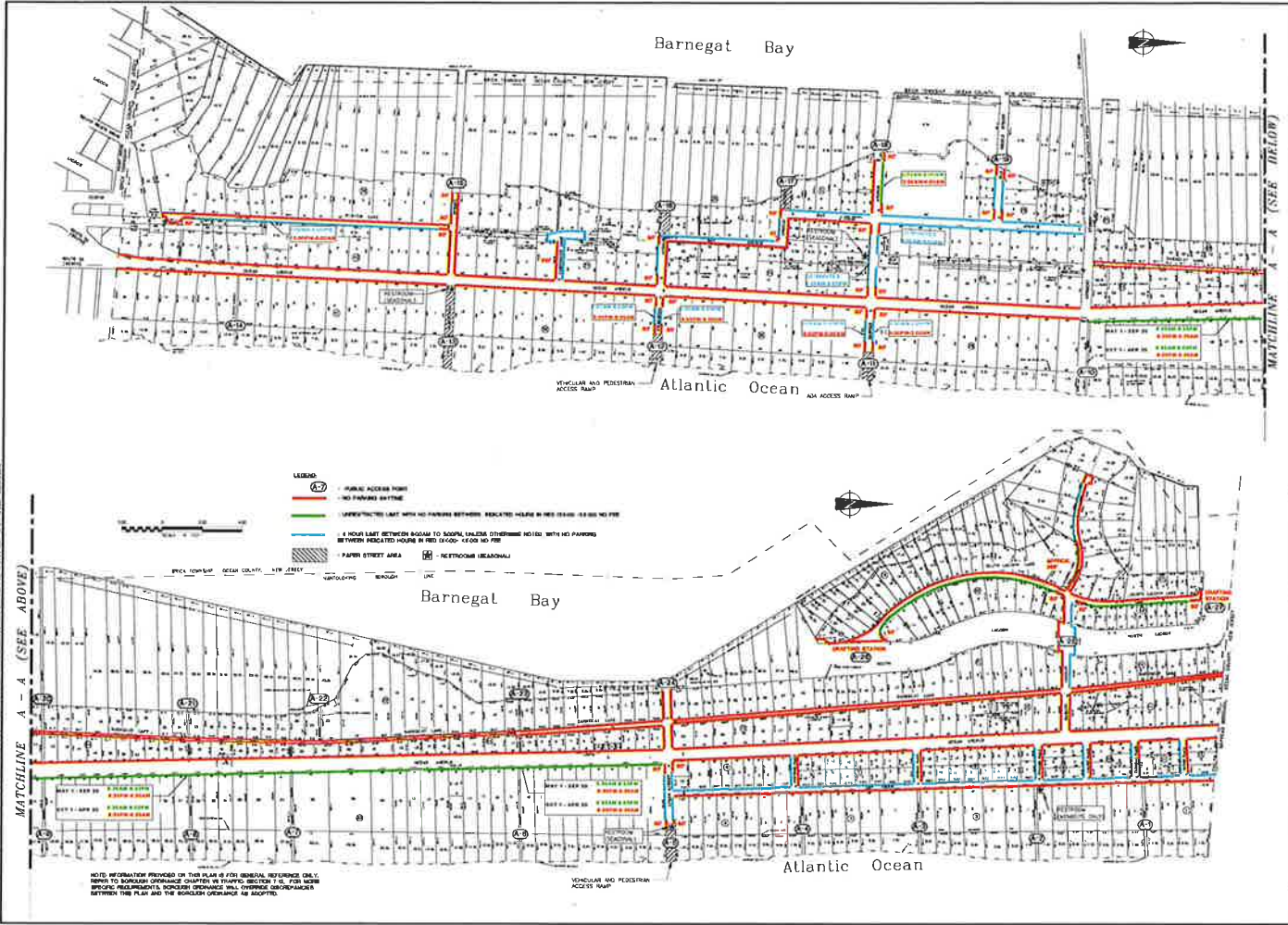

ROBERT C. MANBERGER
Professional Engineer - No. 121 267 210 (NJ) 01/01/2000

M M
MOTT MACDONALD
CONSULTANTS, INC.
1100-201 North 10th Street, Suite 200
Trenton, NJ 08611

BOROUGH OF MANTOLODKING
OCEAN COUNTY, NEW JERSEY
MUNICIPAL PUBLIC ACCESS PLAN
ACCESS & PARKING MAP

304005

DEED OF DEDICATION AND PERPETUAL PUBLIC ACCESS EASEMENT

THIS DEED OF DEDICATION AND PERPETUAL PUBLIC ACCESS is made this day of _____ BY AND BETWEEN THE BOROUGH OF MANTOLOKING, a Municipal Corporation whose address is 202 Downer Ave , Borough of Mantoloking , 087382 _____ Referred to herein as Borough or "Grantor," And the STATE OF NEW JERSEY hereinafter referred to as the "State" or "Grantees",

WITNESSETH

WHEREAS, Grantor is the owner or easement holder of certain tracts of land, located in the Borough of Mantoloking, County of Ocean, State of New Jersey, identified as public access ways located at See attached Table 1 (list of access points and ID #s : A-1 through A-27) _____ as identified in Table 1- Mantoloking Borough Public Access Location (attached , access ways descriptions) and shown on the attached Borough of Mantoloking Municipal Public Access Plan (dated 3-21-2019) consistent with the official tax map of the Borough of Mantoloking, hereinafter the "Property(s);" and Grantor holds the requisite interest to grant this Deed of Easement; and

WHEREAS, the Grantees recognize that tidal waterways and their coastlines at Mantoloking, New Jersey are valuable economic resources to the municipality and the State of New Jersey; and

WHEREAS, access to tidal waterways at Mantoloking, New Jersey is a right provided to the public under the Public Trust Doctrine; and

WHEREAS, in order for the public to access tidal waterways, perpendicular access to these areas must be secured for public use; and

WHEREAS, in order to ensure public access, Grantees need a Perpetual Public Access Easement on portions of said Property(s) herein described; and

WHEREAS, the Borough shall consider this Deed of Easement in establishing the assessed value of any lands subject to such restrictions; and

WHEREAS, this Deed of Dedication and Perpetual Public Access Easement shall be subject to and consistent with any existing public access agreement or easement entered into by the Municipality with the United States Army Corps of Engineers; and

WHEREAS, this Deed of Easement will also serve to implement the Public Trust Doctrine and ensure permanent public access, use and enjoyment of tidal waterways and their shores.

NOW, THEREFORE, the Grantor grants and conveys to Grantee an irrevocable, assignable, perpetual and permanent easement as set forth herein:

GRANT OF EASEMENT: A perpetual and assignable easement and right-of-way across that land of the Property(s) described as public street ends and other locations shown on the attached chart identified as Table 1 - Mantoloking Borough Public Access Location (attached with access ways descriptions: A-1 through A-27) and Mantoloking's Municipal Public Access Plan (MPAP) (attached, dated 3-21-2019) consistent with the official 2019 tax map of the Borough of Mantoloking, hereinafter the "Property(s)," and Grantor holds the requisite interest to grant this Deed of Easement listed above for use by the State of New Jersey and the Borough of Mantoloking, their representatives, agents, contractors and assigns to:

- a. Construct, preserve, patrol, operate, maintain, repair, rehabilitate, and replace a public access area to allow the public access to tidal waterways;
- b. Post signs;

The easement reserves to the Grantor, the Grantor's, successors and assigns the right and privileges as may be used and enjoyed without interfering with or abridging the rights and easements hereby conveyed to the Grantees, subject however to existing easements for utilities and pipelines, existing public highways, existing paved public roads and existing public streets.

Duration of Easement: The easement granted hereby shall be in perpetuity, and in the event that the Borough or the State of New Jersey shall become merged with any other geopolitical entity or entities, the easement granted hereby shall run in favor of surviving entities. The covenants, terms, conditions and restrictions of this Deed of Easement shall be binding upon, and inure to the benefit of the parties hereto and their respective representatives, successors and assigns and shall continue as a servitude running in perpetuity with the land.

Municipality to Maintain Public Access: The Borough agrees, consistent with all Federal, State and local statutes and regulations, that at all times it shall use its best, good-faith efforts to preserve, cause and ensure the public access areas to be maintained, consistent with all applicable Federal, State or local laws or regulations, notwithstanding any action or inaction of the State of New Jersey.

Character of Property(s): Notwithstanding the foregoing, nothing herein is intended or shall be deemed to grant the Grantees or otherwise permit the Grantee to any other person to cross over or use any part of the Property(s) which is not within the Easement Area; nothing herein is intended or shall be deemed to alter the boundary lines or setback lines of the Property(s).

By the acceptance of this Deed of Easement, the Borough agrees, to the extent allowed by applicable law, that the Property(s) burdened by the easement herein described shall not be excluded from the calculations of minimum square footage requirements when construing applications under the Zoning Ordinance of the Borough.

Miscellaneous:

1. The enforcement of the terms of this Easement shall be at the discretion of the Grantees and any forbearance by Grantees to exercise their rights under this Easement in the event of any violation by Grantor shall not be deemed or construed to be a waiver by Grantee of such term or of any subsequent violation or of any of Grantees rights under this Easement. No delay or omission by Grantees in the exercise of any right or remedy upon any violation by Grantor shall impair such rights or remedies or be construed as a waiver of such rights or remedies.
2. The interpretation and performance of this Deed of Easement shall be governed by the laws of the State of New Jersey.
3. If any provisions of this Deed of Easement or the application thereof to any person or circumstance is found to invalid, the remainder of the provision of this Easement or the application of such provisions to person or circumstances other than those to which it is found to be invalid, as the case may be, shall not be affected thereby.
4. Any notice, demand, request, consent, approval or communication under this Deed of Easement shall be sent by regular first-class mail, postage prepaid and by Certified Mail, Return Receipt Requested, addressed to the mailing addresses set forth above or any other address of which the relocation party shall notify the other, in writing.
5. The captions in this Deed of Easement have been inserted solely for convenience of reference and are not a part of this instrument and shall have no effect upon its construction or interpretation.
6. Structures no part of the project are not authorized.

IN WITNESS WHEREOF, with the parties understanding and agreeing to the above, they do hereby place their signature on the date at the top of the first page.

Accepted by the Borough of Mantoloking, Property Owner and/or Easement Holder/
Grantor

E. Laurence White, Mayor

Date: _____

Witnessed by:

NOTARY PUBLIC OF THE STATE OF NEW JERSEY

Accepted by the ____ (State) ____, GRANTEE

By: _____

Date: _____

Witnessed by:

NOTARY PUBLIC OF THE STATE OF NEW JERSEY

Accepted by the State of New Jersey, GRANTEE

By: _____

Date: _____

Witnessed by:

NOTARY PUBLIC OF THE STATE OF NEW JERSEY

STATE OF NEW JERSEY, COUNTY OF _____ SS.:

I CERTIFY that on _____, E. Laurence White, Mayor personally came before me and this person acknowledged under oath, to my satisfaction that this person (or if more than one, each person);

- 1) Is named in and personally signed this Deed of Easement;
- 2) Signed, sealed and delivered this Deed of Easement as his or her act and deed; and

- 3) Holds the requisite ownership interest and authority to execute this Deed of Easement on behalf of the Borough of Mantoloking.

NOTARY PUBLIC OF NEW JERSEY